



## Welcome from The President



To our first class of students:

It gives me a great deal of pride and satisfaction to welcome you, our first students, to California State University Channel Islands. The people of Ventura County have been waiting for you for more than 30 years. The dream of a four-year public university for Ventura County has finally become a reality, and you are the embodiment of that dream. As I have said publicly on numerous occasions, we are here for our students, and you are the reason we exist. I hope and trust that your experience at Cal State Channel Islands will be rewarding and productive, and that you will look back on your years with us with gratification and satisfaction.

There are over 125 courses for you to choose from in this first Schedule of Classes, and I wish you the best of success in each and every one of your courses. We are here to help you succeed, because today and in the years ahead, your success is our success.

Sincerely,

Richard R. Rush  
President



## Table of Contents

### General Contents

Academic Advisement .....	5
Academic Planning Chart .....	6
Academic Policies and Regulations .....	5
Bell Tower Floor Plan .....	31
Campus Map .....	30
Change of Program Chart .....	32
Frequently Asked Questions .....	3
Registration Experience .....	7
Adding / Dropping / Changing Classes .....	8
Complete Withdrawal from the University .....	8
Grades Policy .....	8
Immunization Requirements .....	9
Late Registration Period .....	8
Purpose of the Schedule of Classes .....	7
Special Enrollment Programs .....	9
Student Affairs .....	13
C.H.A.P.s .....	15
New Student Orientation .....	13
Recreation and Leisure .....	14
Student Activities .....	14
University Fees and Refunds .....	10
Financial Aid .....	11
Transportation and Parking Services .....	12
Refunds .....	10
Student Financial Services .....	10

### Fall 2002 Course Offerings: Majors and Credential

Alphabetical Course Listing .....	22
Course Numbering .....	16
General Education .....	16
Art .....	16
Biology .....	16
Business .....	17
Computer Science .....	18
English .....	18
Environmental Science and Resource Management .....	19
Liberal Studies (Interdisciplinary Option) .....	20
Liberal Studies (Teaching and Learning Option) .....	20
Liberal Studies (Concentrated Studies Option) .....	21
Mathematics .....	21
Multiple Subject Teaching Credential .....	22

### Campus Service Directory

Admissions & Records .....	27
Academic Advisement (General) .....	27
Academic Affairs .....	27
Associated Students .....	27
Bus Services .....	27
Cashier's Office .....	27
Campus Clubs & Organizations .....	27
Career, Health Accommodations, Personal Counseling Services, Career Planning and Preparation .....	27
Credential Advisement .....	27
Disability Accommodation Services .....	27
Extended Education .....	27
Faculty and Staff Directory .....	29
Financial Aid .....	27
Fitness Center .....	27

Judicial Affairs .....	27
Library Services .....	27
Lost and Found .....	27
Open University .....	27
Orientation .....	27
Outreach and Recruitment .....	27
Parking Services .....	28
Personal and Psychological Counseling Services .....	28
Police Department .....	28
President (Office of the) .....	28
Recreation and Leisure Services .....	28
Student Affairs (Vice President) .....	28
Student Development .....	28
Student Financial Services .....	28
Student Health Services .....	28
Student ID .....	28
Student Store (Bookstore) .....	28
TDD (805) 437-8510 .....	
Technology Center .....	28
The Hub—"Student Union" .....	28
Tours-Campus .....	28
Transportation Services .....	28



### University Mission

California State University Channel Islands provides undergraduate and graduate education that facilitates learning within and across disciplines through integrative approaches, emphasizes experiential and service learning, and graduates students with an international perspective that includes facility in two languages. To accomplish its mission, the university strives to create learning communities that involve all elements of the university, integrate community and university resources, build community-university partnerships, engage the educational community from preschool through community college, provide opportunities for adult education and lifelong learning, and preserve and enhance the culture and environment of the region.



## Frequently Asked Questions

**Q: Will there be any type of orientation for admitted fall 2002 Cal State Channel Islands students?**

**A:** A comprehensive program called Island View Orientation is scheduled for July and August. Reservations are required and an invitation will be mailed to all admitted students. This is an important opportunity to become acquainted with the University and its many services, as well as meet with an academic advisor and register for classes.

**Q: When will student housing be available on campus?**

**A:** We anticipate that on-campus housing will be available in fall 2004. In an effort to preserve our beautiful 1930's architecture, current buildings will be renovated for campus residence halls.

**Q: Can I still apply to CSU Channel Islands for fall 2002?**

**A:** At the time this Schedule was printed, CSU Channel Islands remained open for fall 2002. Check with Admissions and Records at CSU Channel Islands if you are interested in applying for admission.

**Q: What student clubs can I join?**

**A:** One of the many exciting things that awaits you—our first class—is an opportunity to help form our student clubs. Students such as yourself will create a variety of clubs—social, academic, and sports—with the guidance and support of staff and faculty. Island View Orientation will give you more information about student clubs. Remember ... we're counting on you to become involved!

**Q: Cal State Northridge maintains a library on the Channel Islands campus. Will Cal State Channel Islands students have access to these library resources?**

**A:** Yes, you will have access to all library resources. Our new John S. Broome library is slated to open in 2005 and will be state of the art!

**Q: What should I do if I want to change my major? Or add a minor?**

**A:** If you are planning to change your major or add a minor, please call and schedule an appointment with the Academic Advisement Center. The Center will assist you with the change of major process and provide you with all appropriate paperwork.

**Q: How can I get advisement regarding the classes I should take this fall?**

**A:** Fall 2002 students who have been admitted will be invited to Island View Orientation. Plan to attend this important event to meet with program advisors and register for your classes. Be sure to respond to the invitation so we can prepare for your arrival.

**Q: Do I have to buy a parking permit to park on campus?**

**A:** Yes, you need a parking permit to park on campus. By participating in the Island View Orientation you will have the opportunity to speak with our parking services representatives and purchase your fall semester parking permit. Please refer to the Campus Services Directory in this Schedule for the phone number and location of Parking Services (Office of Public Safety). For additional means of transportation (including shuttle services) and other information, please visit the Website: [www.csuci.edu:16080/parking/](http://www.csuci.edu:16080/parking/)

**Q: Will Cal State Channel Islands be adding more majors and minors? What about graduate programs?**

**A:** As Cal State Channel Islands grows, we will be adding more majors and minors each year, as well as Master's programs. Please check with the Academic Advisement Center for an up-to-date list of new degree programs planned for CSU Channel Islands.

**Q: Can I enroll in CSUN courses held on the Channel Islands campus?**

**A:** The CSU System has a program called "Intrasystem Concurrent Enrollment" which is designed for students wishing to enroll at two CSU campuses for one semester. You must meet certain requirements to participate in this program. Contact the Office of Admissions and Records for procedures and deadlines. Students receiving financial aid must contact the Financial Aid office prior to enrollment. Students should also meet with a Program Advisor to ensure they can receive appropriate course credit.

**Q: Will Cal State Northridge students attend classes here on the Channel Islands campus?**

**A:** Yes, Cal State Northridge has operated a satellite campus in Ventura County since 1974. In the summer of 1999, the Ventura campus relocated from the city of Ventura to the Channel Islands site and has been offering a number of degree programs since that time. Both universities—Cal State Channel Islands and Cal State Northridge—will continue to offer separate degree programs over the next few years. The programs offered by CSUN will gradually be brought to a close.

**Q: Will all of my classes be held in the Bell Tower Building?**

**A:** With the exception of a few courses, almost all of your classes will take place in the Bell Tower Building. Prior to the beginning of the semester, classroom locations will be posted via the web at: [www.csuci.edu](http://www.csuci.edu) under Schedule Of Classes.



## July 2002

S	M	T	W	T	F	S
	1	2	3	4	5	6
7	8	9	10	11	12	13
14	15	16	17	18	19	20
21	22	23	24	25	26	27
28	29	30	31			

## August 2002

S	M	T	W	T	F	S
				1	2	3
4	5	6	7	8	9	10
11	12	13	14	15	16	17
18	19	20	21	22	23	24
25	26	27	28	29	30	31

## September 2002

S	M	T	W	T	F	S
1	2	3	4	5	6	7
8	9	10	11	12	13	14
15	16	17	18	19	20	21
22	23	24	25	26	27	28
29	30					

## October 2002

S	M	T	W	T	F	S
		1	2	3	4	5
6	7	8	9	10	11	12
13	14	15	16	17	18	19
20	21	22	23	24	25	26
27	28	29	30	31		

## November 2002

S	M	T	W	T	F	S
					1	2
3	4	5	6	7	8	9
10	11	12	13	14	15	16
17	18	19	20	21	22	23
24	25	26	27	28	29	30

## December 2002

S	M	T	W	T	F	S
1	2	3	4	5	6	7
8	9	10	11	12	13	14
15	16	17	18	19	20	21
22	23	24	25	26	27	28
29	30	31				

## January 2003

S	M	T	W	T	F	S
			1	2	3	4
5	6	7	8	9	10	11
12	13	14	15	16	17	18
19	20	21	22	23	24	25
26	27	28	29	30	31	

## February 2003

S	M	T	W	T	F	S
						1
2	3	4	5	6	7	8
9	10	11	12	13	14	15
16	17	18	19	20	21	22
23	24	25	26	27	28	

**Fall 2002 CSU Channel Islands  
University Calendar**

July 4	Independence Day; offices closed; no instruction.
July 19	*New Student Orientation; 8:15-4:00 p.m.
July 27	*New Student Orientation; 8:15-4:00 p.m.
July 31	*New Student Orientation; 8:15-4:00 p.m.
August 1	Application period for spring 2003 begins.
August 10	*New Student Orientation; 8:15-4:00 p.m.
August 13	*New Student Orientation; 8:15-4:00 p.m.
August 21	*New Student Orientation; 12:30-8:00 p.m.
August 24	SATURDAY CLASSES BEGIN.
August 26	First official day of classes; change of program begins.
September 2	Labor Day holiday; all offices closed; no instruction.
September 6	Last day to add a class with instructor approval; drop a class without approval; or change the basis of grading without approval.
September 23	Fall 2002 Census date.
October 11-13	Family Weekend!
November 1	Application period for spring 2003 begins.
November 28-30	Thanksgiving holiday; all offices closed; no instruction.
November 29	Admission Day observed.
December 1	Last day of formal instruction; except for Saturday classes meeting once weekly; Thursday and Friday may be used for review.
December 9-14	Final examinations.
December 16-17	Departmental meetings and conferences.
December 18	Evaluation day.
December 19-20	Instructor's grades due.
December 20	Official last day of the fall 2002 semester.
December 23-	
January 1, 2003	Holiday closure; all offices closed; no instruction.

\*Island View Orientation packets will be sent to admitted students prior to the event. Be sure to RSVP in order to attend. (Dates subject to change)

**Spring 2003 CSU Channel Islands  
University Calendar**

January 23-24	Faculty Orientation.
January 27	Classes begin.
March 31	Cesar Chavez Holiday; all offices closed; no instruction.
April 14-18	Spring Recess; all offices closed; no instruction.
May 16	Last day of formal instruction; except for Saturday classes meeting once weekly. Thursday and Friday may be used as review days.
May 19-24	Final examinations.
May 23	Commencement.
May 26	Memorial Day holiday; all offices closed; no instruction.
May 29-30	Instructor's grades due.
May 30	Last day of academic year.

**Changes in Rules and Policies**

Although the Schedule of Classes was prepared on the basis of the best information available at the time, all information including class meeting times, course offerings and statement of fees are subject to change without notice or obligation. The University does not guarantee the availability of a particular course or section.

## March 2003

S	M	T	W	T	F	S
						1
2	3	4	5	6	7	8
9	10	11	12	13	14	15
16	17	18	19	20	21	22
23	24	25	26	27	28	29
30	31					

## April 2003

S	M	T	W	T	F	S
		1	2	3	4	5
6	7	8	9	10	11	12
13	14	15	16	17	18	19
20	21	22	23	24	25	26
27	28	29	30			

## May 2003

S	M	T	W	T	F	S
				1	2	3
4	5	6	7	8	9	10
11	12	13	14	15	16	17
18	19	20	21	22	23	24
25	26	27	28	29	30	31

## June 2003

S	M	T	W	T	F	S
1	2	3	4	5	6	7
8	9	10	11	12	13	14
15	16	17	18	19	20	21
22	23	24	25	26	27	28
29	30					



## Academic Policies and Regulations

### Statement of Nondiscrimination and Disability Services Information

California State University Channel Islands prohibits discrimination or harassment based on sex, gender, race, color, religion, national origin or ancestry, age, disability, marital status, sexual orientation, cancer-related medical condition, or genetic predisposition. The University also prohibits discrimination against anyone due to a relationship or association with an individual with a known disability.

The University practices equal opportunity in admission to, access to, and operation of instruction, programs, services, and activities. Also, the University provides equally effective communication.

The University considers reasonable accommodation for these purposes (a) completion of the admission and enrollment processes, (b) participation in instruction, programs, services and activities, and (c) equally effective communication, upon request by persons with legally protected disabilities.

Questions, concerns, complaints, and requests for reasonable accommodation or additional information may be forwarded to the Office of Career, Health, Accommodations, Personal Counseling Services, (805) 437-8510 (voice and TDD).

### Use of Social Security Number

Applicants are required to include their social security number (taxpayer identification number) in designated places on applications for admission pursuant to the authority contained in Section 41201, Title 5, California Code of Regulations, and Section 6109 of the Internal Revenue Code. The University uses the social security number to identify records pertaining to the student as well as to identify the student for purposes of financial aid eligibility and disbursement and the repayment of financial aid and other debts payable to the institution. Also, the Internal Revenue Service requires the University to file information returns that include the student's social security number and other information such as the amount paid for qualified tuition, related expenses, and interest on educational loans. This information is used by the IRS to help determine whether a student, or a person claiming a student as a dependent, may take a credit or deduction to reduce federal income taxes.

### Privacy Rights of Students in Education Records

The Federal Family Educational Rights and Privacy Act of 1974 (20 U.S.C. 1232g) and regulations adopted thereunder (34 C.F.R. 99) set out requirements designed to protect the privacy of students concerning their records maintained by the campus. Specifically, the statute and regulations govern access to student records maintained by the campus, and the release of such records. In brief, the law provides that the campus must provide students access to records directly related to the student and an opportunity for a hearing to challenge such records on the grounds that they are inaccurate, misleading or otherwise inappropriate. The right to a hearing under the law does not include any right to challenge the appropriateness of a grade as determined by the instructor. The law generally requires that written consent of the student be received before releasing personally identifiable data about the student from records to other than a specified list of exceptions. The institution has adopted a set of policies and procedures concerning implementation of the statutes and the regulations on the campus. Copies of these policies and procedures may be obtained at the Admis-

sions and Records Office in the Bell Tower Building. Among the types of information included in the campus statement of policies and procedures are: (1) the types of student records and the information contained therein; (2) the official responsible for the maintenance of each type of record; (3) the location of access lists that indicate persons requesting or receiving information from the record; (4) policies for reviewing and expunging records; (5) the access rights of students; (6) the procedures for challenging the content of student records; (7) the cost which will be charged for reproducing copies of records; and (8) the right of the student to file a complaint with the Department of Education. An office and review board have been established by the Department to investigate and adjudicate violations and complaints. The office designated for this purpose is: Family Policy Compliance Office, U.S. Department of Education, Washington, D.C. 20202-4605.

The campus is authorized under the Act to release "directory information" concerning students. "Directory information" may include the student's name, address, telephone listing, electronic mail address, photograph, date and place of birth, major field of study, participation in officially recognized activities and sports, weight and height of members of athletic teams, dates of attendance, degrees and awards received, and the most recent previous educational agency or institution attended by the student. The above designated information is subject to release by the campus at any time unless the campus has received prior written objection from the student specifying information which the student requests not to be released. Written objections should be sent to the Admissions and Records Office in the Professional Building.

The campus is authorized to provide access to student records to campus officials and employees who have legitimate educational interests in such access. These persons are those who have responsibilities in connection with the campus's academic, administrative or service functions and who have reason for using student records connected with their campus or other related academic responsibilities. Disclosure may also be made to other persons or organizations under certain conditions (e.g., as part of the accreditation or program evaluation; in response to a court order or subpoena; in connection with financial aid; to other institutions to which the student is transferring).

## Academic Advisement

Cal State Channel Island's primary focus is on student-centered education and services. The academic advising mission is to promote student success by providing high quality advising services to all students.

For general advising and Liberal Studies advising students go the ACADEMIC ADVISING CENTER, located on the first floor of the Bell Tower Building. Students may schedule appointments with academic advisors Monday – Thursday, 8:00 – 6:00 p.m. and on Friday from 8:00 – 5:00 p.m. To schedule an appointment, please call 437-8571.

General advisors can assist students with:

- General education and graduation requirements
- Understanding institutional policies and procedures
- Information about academic probation policies, remediation strategies, and course repeat procedures
- Understanding degree audit and other University documents





# Cal State Channel Islands

## Academic Planning 2002 / 2003

Ticket #	Dept./Course Number	Units	Day/Time

### Total Units:

Review the CSU Channel Islands Schedule of Classes and complete the semester planner above. When planning your schedule, consider time for tutoring, library work, labs, the best time to attend classes, your work schedule, study habits and a realistic assessment of your ability and interests.

After completing your class schedule, in the table below, indicate the requirement each course will fulfill.

Semester:		Year:	
Prerequisite	Gen Ed	Major	Elective

Bring this completed planner to Island View Orientation. CSUCI's academic advisors are looking forward to assisting you with your future academic planning.

## Semester Time Management Schedule

Hour	Semester					Year	
	Monday	Tuesday	Wednesday	Thursday	Friday	Saturday	Sunday
8:00 a.m.							
9:00 a.m.							
10:00 a.m.							
11:00 a.m.							
12:00 p.m.							
1:00 p.m.							
2:00 p.m.							
3:00 p.m.							
4:00 p.m.							
5:00 p.m.							
6:00 p.m.							
7:00 p.m.							
8:00 p.m.							
9:00 p.m.							

Balance your schedule! A typical academic schedule is 12 to 15 units of coursework. Strive to achieve a balance of classes consistent with the demands on your time and your personal lifestyle.



- Academic program planning such as semester-by-semester planning, selection of specific courses, the registration process, and schedule adjustments
- A comprehensive referral service for campus resources

For advisement in your major, you will need to meet with the designated faculty advisor in your major discipline. Students should contact the ACADEMIC ADVISING CENTER located in the Bell Tower Building (437-8571) for a list of faculty advisors and availability. Faculty advisors are available to:

- Assist with major course substitutions
- Assist with major course selections
- Help students understand major requirements for graduation
- Complete graduation check for the major
- Provide assistance with internship opportunities
- Mentor students by exploring career options
- Provide information about graduate school options

### New Student Advisement

Please note the Program Advisors available at the Channel Islands campus and contact them to schedule an appointment. Undergraduates should plan to bring an unofficial copy of transcripts for advisement purposes. Please contact the appropriate Program Advisor to schedule an appointment.

### Advisement Resources

#### General Advisement & Liberal Studies

Sue Saunders (advisement@csuci.edu)  
(805) 437-8571

### Faculty Advisors

#### Art

Prof. Jack Reilly (jack.reilly@csuci.edu)  
(805) 437-8863

#### Biology

Prof. Ching-Hua Wang (ching-hua.wang@csuci.edu)  
(805) 437-8870

#### Business

Prof. Dennis Muraoka (dennis.muraoka@csuci.edu)  
(805) 437-8861

#### Computer Science

Prof. Peter Smith (peter.smith@csuci.edu)  
(805) 437-8882

#### Education

Prof. Joan Karp (joan.karp@csuci.edu)  
(805) 437-8871

#### English

Prof. Jacque Kilpatrick (j.kilpatrick@csuci.edu)  
(805) 437-8865

#### Environmental Science and Resource Management

Assoc. Prof. Bill Adams (bill.adams@csuci.edu)  
(805) 437-8866

### Liberal Studies

Liberal Studies Advisor  
Academic Advisement Center

### Mathematics

Prof. Ivona Grzegorzczak (ivona.grze@csuci.edu)  
(805) 437-8868

## Registration Experience

### Purpose of the Schedule of Classes

As a Cal State Channel Islands Student, it is your responsibility to read and understand the Schedule of Classes. You are expected to understand academic policy, adhere to the academic deadlines and to follow correct registration procedures. The aim of this schedule is to provide you with the information you need to enroll in classes by:

- **Furnishing** a list of classes offered for the fall 2002 semester. When planning a schedule, you should be aware of any specific prerequisites.
- **Advising** you of current deadlines, fee information, etc. This schedule instructs you on where to seek advice on how to plan your academic schedule, how to change your program, and on other academic procedures.
- **Outlining** those courses that may be taken to fulfill general education requirements. Obtain an updated list of General Education requirements from the Academic Advising Center.

### Schedule of Classes via the Web

This schedule of classes is a guide only. While every effort has been made to ensure its accuracy, this information is subject to change without notice. Consult the University Catalog for the most current course descriptions and prerequisites.

The Schedule of Classes will also be available online for you to look up course information for the upcoming semester. Two weeks prior to classes beginning, visit the Website at [www.cscui.edu](http://www.cscui.edu) and see Class Schedule in order to check the location of your classes. Prior to the semester, easels will also be displayed at the front and rear entrances to the Bell Tower Building so that you may check the locations of your classes as well.

### Change of Program

It is your responsibility to initiate action when an adjustment in your program of study is necessary, i.e., adding, dropping or changing classes. Change of Program forms are available at the Office of Admissions and Records. Students are responsible for filing these forms properly and for paying the required fees. The filing period begins on the first day of classes. Students must file by the appropriate deadlines and are encouraged to file early. Note: It is your responsibility to ensure that all Change of Program forms are filed at the Admissions and Records Office by the appropriate deadline.

Please refer to the inside back cover of this schedule for Approval Authorization for Change of Program and Withdrawal Chart.



### **Adding**

All adds require instructor approval and signature on the Change of Program Form beginning with the first day of instruction.

**The last day to add a class is 4:00 p.m.,  
Friday, September 6, 2002**

### **Dropping**

A student may withdraw from any course during the first two weeks of instruction on the Change of Program form without an instructor's approval.

**The last day to drop a class is 4:00 p.m.,  
Friday, September 6, 2002.**

### **Changing**

Changing the basis of grading to Credit/No-Credit or to a regular letter grade can be accomplished during the first two weeks of instruction on the Change of Program form without an instructor's approval if that grading option is available.

**The absolute last day to change the basis of grading is  
4:00 p.m. Friday, September 6, 2002.**

### **Late Registration Period**

Late registration is conducted during the first two weeks of classes. You must secure a Change of Program form from the Office of Admissions and Records; obtain the approval of the instructor(s); and submit the form to the Office of Admissions and Records prior to 4:00 p.m. on Friday of the second week of classes. You may want to consult with the Academic Advising Center to plan your schedule. A non-refundable \$25.00 late registration fee is charged in addition to the regular registration fee. NOTE: You must be admitted to the University in order to register. All late registrations must be filed in the Office of Admissions and Records no later than 4:00 p.m. on Friday of the second week of classes.

### **Complete Withdrawal from the University**

Students who find it necessary to withdraw from CSU Channel Islands after enrolling for any academic term are required to follow the official withdrawal procedures. Failure to follow these procedures may result in the assignment of failing grades in all courses and the need to apply for readmission before being permitted to enroll in another academic term. Information on withdrawal procedures is available from the Advisement Office.

Students who are receiving financial aid funds must consult with the Financial Aid Office prior to withdrawing from the University regarding any required return or repayments of grant or loan assistance received for that academic term. If a recipient of financial assistance under federal Title IV financial aid programs withdraws from the institution during a payment period, the amount of grant or loan assistance received is subject to return and repayment provisions governed by federal law.

### **Nonattendance Policy**

An instructor may drop a student who does not attend class and has not made prior arrangements with the instructor. This may occur as early as the first class meeting.

### **Academic Program Verification**

At the end of the third week of instruction, the Office of Admissions and Records will mail students a copy of their official academic program. It is your responsibility to ensure that your academic program is accurate. Any enrollment discrepancies should be brought in person to the Office of Admissions and Records for correction. Students are encouraged to take immediate action; failure to correct an academic program discrepancy may result in a grade of "U" for an official enrollment in a course never attended.

### **Administrative Action on Prerequisites**

An instructor may drop a student who has enrolled in a class requiring permission of the instructor or completion of prerequisites if the student has not properly secured this permission or satisfactorily completed the prerequisites before enrolling.

### **Simultaneous Enrollment**

It is the policy of CSU Channel Islands that no student shall be permitted to enroll simultaneously in any two or more classes meeting during the same time period. An instructor may initiate the administrative withdrawal of a student enrolled in another class meeting at the same time.

### **Grade Policy**

1. The "ABCD" is the default grading system.
2. Although it is not required, individual faculty members may add a "+" or "-" to any grade except "F." By adding a "+" to a grade, the grade points earned increase by 0.3 (except an A+ shall still be 4.0 grade points). By adding a "-" to a grade, the grade points earned shall decrease by 0.3. Course syllabi are required to state clearly whether "+/-" grading is used.
3. A student may take a course "CR/NC" if the course is designated as allowing "CR/NC" grading in the course approval process.
4. Not more than 12 units of General Education courses may be taken "CR/NC."
5. The decision on how many units of courses taken "CR/NC" and which courses can be taken "CR/NC" is left up to each individual program.
6. Course syllabi shall include a discussion of the instructor's grading policy.

### **Policy on Course Grade Appeals**

1. Each student has the right to appeal the final course grade, but only the final course grade. A student may not appeal individual assignments and examinations.
2. Appeals are limited to situations in which the student believes the grade was "prejudicially," "capriciously," or "arbitrarily" assigned.
3. The appeal must be initiated within the first regular semester after assignment of the grade. It must first be directed to the instructor of the course, orally or in writing. If further action is necessary, the student should appeal in writing to the program





coordinator. If further action is necessary, the issue may be appealed to the University Grade Appeals Committee.

4. Individuals may not participate as a member of the University Grade Appeals Committee in the review of an appeal if they are a participant in an appeal.
5. The decision of the University Grade Appeals Committee is final.

### Policy on Forgiveness of Previously Earned Grade (Repeat and Delete)

You may repeat a course for the purposes of improving your GPA. Courses in which the grade is C or above can be replaced up to a maximum of 24 units; however, there is no limit on the number of units that can be retaken for courses with grades of C- or lower. Only the higher grade in a course will be used in calculation of the grade point average if forgiveness is granted.

### Policy on Honors at Graduation

#### University Honors:

The following honors are awarded to students graduating from CSU Channel Islands:

**Summa Cum Laude**—this honor is awarded to all students who possess a grade point average of 3.90 - 4.0 in courses taken at CSU Channel Islands.

**Magna Cum Laude**—this honor is awarded to all students who possess a grade point average of 3.75 - 3.89 in courses taken at CSU Channel Islands.

**Cum Laude**—this honor is awarded to all students who possess a grade point average of 3.50 - 3.74 in courses taken at CSU Channel Islands.

#### Program Honors:

Program honors will be awarded based on criteria developed by individual programs.

### Measles and Hepatitis B Immunization Requirements

All students born after January 1, 1957 are required to submit proof of measles and rubella immunization by the end of their first year. **Students will not be able to register for classes in their second year until this requirement is met.**

New students aged 18 or under are required to provide proof of full immunization against the hepatitis B virus prior to enrollment. Students who have not completed the series of 3 vaccinations will be given a grace period of 2 semesters in which to comply. **Students will not be able to register for classes in their second year until this requirement is met.**

### Policy on Credit Toward Graduation For Courses Taken Outside Cal State Channel Islands

A student may earn credit toward graduation for courses taken outside Cal State Channel Islands as follows:

#### Transfer of Undergraduate and Graduate Credit from Another Accredited Institution

Students who were in good standing at another accredited institution

may, within maximums, transfer credit for baccalaureate or graduate degree course work. Course equivalency for major requirements is subject to the determination and discretion of the University; students are cautioned that the University is under no obligation to accept transferred courses for subject credit in addition to unit credit for admission. The policy regarding transfer of courses from California community colleges differs in some respects. Individual program regulations for specific transfer limitations should be consulted.

#### Transfer of Undergraduate Credit from Accredited Community Colleges

A maximum of 70 semester units earned in a community college may be applied toward the baccalaureate degree, with the following limitations and stipulations:

1. No upper division credit may be allowed for courses taken in a community college;
2. No credit may be allowed for professional courses in education taken in a community college, other than introduction to education courses;
3. Students who transfer General Education certification are still required to complete at least 9 units of upper-division General Education courses at CSUCI.

#### Extension Courses

Students may take extension courses without matriculating at CSUCI provided that they meet course prerequisites. Extension courses may be applied to degree and credential requirements with approval of the degree program coordinator. Extension courses do not satisfy the University's residence requirement for graduation. Up to 24 units earned through Open University (see Open University) and Extension may be applied to a bachelor's degree, and up to 9 units may be applied to a master's degree.

#### International Program Credit

Course credits earned in universities abroad may be accepted for degree credit subject to evaluation by the Office of Admissions and Records. Specific course equivalencies may require consultation with individual program coordinators. CSU Channel Islands students who desire, subsequently, to take courses at a foreign university for degree credit must have each such course approved in advance in writing by the program coordinator.

### Special Enrollment Programs

#### Intrasystem Concurrent Enrollment

This program permits students to enroll for classes at Cal State Channel Islands and another CSU campus simultaneously. There is no limitation to the number of times a student may enter this program, as long as an application is filed each semester within the application deadlines outlined by the host campus. Please consult your program advisor and financial aid representative. Contact the Office of Admissions and Records for the Intrasystem Concurrent Enrollment application.

#### Intrasystem Visitor Enrollment

This program permits students to enroll solely at a CSU campus different from their home campus. Registration fees are paid to the host campus (the campus which the student is visiting). Financial aid recipients should check with a financial aid representative at their home campus.



### Procedure for Enrollment in Regular Classes Through Open University

Open University permits non-matriculated students to register in regular classes on a space available basis. Up to 24 units earned through Open University and Extension may be applied to a bachelor's degree, and up to 9 units may be applied to a master's degree.

Individuals who have not been formally admitted to the University may register through Extended Education as an Open University student for regular classes by securing the approval of the instructor and paying Extension fees. Students are expected to meet any course prerequisites and are subject to Open University Extension regulations regarding change of program, fees, refunds, and grades.

Students should attend desired classes for the first week. If space is available after the first week of classes, and with the appropriate approval, students may register at the Office of Admissions and Records. Full payment of fees is due at the time of registration.

Participation in the Open University Program does not constitute admission to the University nor does it entitle individuals to services available to regular students with the exception of library privileges.

#### Open University Fees

Lecture Unit:	\$155
Activity Unit:	\$185
Lab Unit:	\$244

## University Fees and Refunds

### Student Financial Services

Student Financial Services is located on the first floor of the Professional Building. To resolve financial issues, please stop by:

Monday–Thursday	9:00 a.m.– 7:00 p.m.
Friday	8:00 a.m.– 5:00 p.m.
Saturday	8:30 a.m.– 12:30 p.m.

Extended hours of operation the first three weeks of the semester (August 26 to September 13, 2002) are:

Monday - Thursday	9:00 a.m.– 8:00 p.m.
-------------------	----------------------

**FEES ARE SUBJECT TO CHANGE BY THE TRUSTEES OF THE CALIFORNIA STATE UNIVERSITY;** students will be billed for any fee increase approved by the legislature.

**NOTE: Graduates must pay the higher of the two fee categories. A graduate is defined as any student having already earned a bachelor's degree from an accredited institution.**

### Registration Fees

The regular fees of the University are listed below. Your check, money order, or cashier's check should be made payable to CSU Channel Islands. Credit card payment is available (Visa or MasterCard only). Do not send cash in the mail. The proposed California resident registration fees are:

### Undergraduate Fees

Fee Category (units)	0-6.0	6.1+
State University Fee	\$414.00	\$714.00
Associated Students Fee	*	*
Student Union Fee	*	*
Instructionally Related Activities Fee	50.00	50.00
Health Facilities Fee	3.00	3.00
Student Health Services Fee	60.00	60.00
Materials, Services, & Facilities Fee	35.00	35.00
<b>Total Registration Fees</b>	<b>\$562.00</b>	<b>\$862.00</b>

### Graduate Fees

Fee Category (units)	0-6.0	6.1+
State University Fee	\$438.00	\$753.00
Associated Students Fee	*	*
Student Union Fee	*	*
Instructionally Related Activities Fee	50.00	50.00
Health Facilities Fee	3.00	3.00
Student Health Services Fee	60.00	60.00
Materials, Services, & Facilities Fee	35.00	35.00
<b>Total Registration Fees</b>	<b>\$586.00</b>	<b>\$901.00</b>

\*Associated Student and Student Union fees to be determined by a student referendum in the fall 2002 term.

### Refund of Registration & Nonresident Fees

Effective fall 2002, a new refund system has been approved by the CSU Board of Trustees. Significant changes have been made to the refund policy that will affect the amount of refund you may receive.

All refunds for mandatory fees are now automatic. Refund checks will be mailed to the address on file with Admissions and Records. Please make sure that your address is correct. Payments made by Visa or Mastercard will be credited back to the original card.

### Cancellation of Registration Prior to the Beginning of the Term

A student will be eligible for a full refund if fees are paid but no enrollment occurred or if all classes have been dropped prior to the first day of instruction for the term. Procedures for withdrawal are available in Admissions and Records or in this Schedule of Classes.

Students will also receive a full refund of mandatory fees and nonresident tuition under the following circumstances:

- The tuition and mandatory fees were collected in error
- The course for which the tuition and mandatory fees were assessed or collected was cancelled by the University
- The University makes a delayed decision that the student was not eligible to enroll in the term for which the mandatory fees were assessed and collected, and the delayed decision was not due to incomplete or inaccurate information provided by the student
- The student was activated for compulsory military service

**Prorated Refunds for Complete Withdrawals**

Beginning with the first day of instruction for the term, refunds for complete withdrawals will be prorated based on the date of withdrawal and the length of the academic period up to the 60% point of the term. Refunds are processed automatically. A student who officially withdraws after the 60% point in the academic period will not be entitled to a refund.

**Nonresident Fees:**

Nonresident students must pay the resident registration fees plus \$282.00 per unit. With prior approval, students have the option to pay registration fees in three installments. Check with Student Financial Services for complete details.

**Note:** In accordance with University policy, the Channel Islands campus gives preference in course enrollment to students already matriculated in the University. Individuals taking courses through "Open University" will be enrolled if space is available. (Fees subject to change by the trustees of the California State University; students will be billed for any fee increase approved by the legislature.)

**Registration Fee Installment Plan**

All students may apply to participate in the registration installment plan (IPP) to pay registration fees in a predetermined payment schedule. An approved IPP contract may be obtained from Student Financial Services. A student's prior financial activity must demonstrate credit worthiness in order to be approved to participate in the IPP. The IPP includes an initial payment and two additional payments during the current semester.

Installment Payment Plan applications and additional information are available at Student Financial Services. A non-refundable administrative fee of \$33.00 per semester is required for participation in the installment plan. The initial payment includes 1/3 of the state university fee and/or 1/3 of the applicable tuition charges, all campus based fees, and administrative fees. Two additional equal installments of the remaining state university fee and/or tuition charges will be due on the published due dates. Failure to complete your obligation under the terms of the IPP will result in the termination of University services and enrollment eligibility (disenrollment.)

**Financial Aid**

Students who have accepted a financial aid award will be able to postpone payment of registration fees until August 26th. Financial aid awards will first be used to satisfy any obligations owed to the university. If the total aid available is not sufficient to pay fees, or if the student loses financial aid eligibility, the student is responsible for payment of fees.

To qualify for a financial aid disbursement students must be enrolled in at least 12 units. This is considered the minimum full time load and will result in full financial aid eligibility. Students enrolling less than full time may have their aid reduced. Most financial aid programs have minimum unit requirements that must be met or aid from those programs may be cancelled completely. If you completely withdraw from school, you may be required to repay some or all of your financial aid.

**Special Course Fees (Lab Fees)**

Several courses require the payment of special course fees (lab fees) as a condition of enrollment. These fees are indicated in the Schedule of Classes next to the course listing. Students will be invoiced for lab fees incurred as a result of enrollment. Lab courses dropped by the refund deadline will automatically be credited on the student's account. Lab courses dropped after the deadline will require a Lab Refund form from the department. Lab fees may be paid with registration fees, when they are billed, or in person at Student Financial Services.

**Other Fees and Charges (Nonrefundable)**

Application fee.....	\$55.00
Campus ID card .....	\$15.00
Replacement campus ID card .....	\$15.00
Check Return fee.....	\$25.00
Credit Card Transaction Dishonored fee.....	\$25.00
Diploma fee.....	\$45.00
Freshman Orientation fee.....	\$40.00
Transfer Orientation fee .....	\$25.00
Installment Plan fee.....	\$33.00
Late registration processing fee .....	\$25.00
Library fees .....	(varies)
Parking Permit Replacement fee.....	\$10.00

**Refunds for Partial Withdrawals**

A student who drops some, but not all units resulting in a lower tuition and/or mandatory fee obligation by the published deadline, will be entitled to a refund of the applicable difference in fees. Refunds are processed automatically. A student who fails to drop classes that would result in a lower fee category by the deadline will not be entitled to a refund.

**NOTE:** It is the sole responsibility of the student to withdraw from classes. Refunds can only be issued to students who withdraw from classes by the published deadlines. Students are responsible for verifying their withdrawal from classes.

**Attention Students!!****Important Fall 2002 Refund Policies and Procedures**

- For a full refund, all classes must be dropped prior to the first day of instruction. Beginning the first day of classes, your refund will be pro-rated.
- All refunds for mandatory fees are now automatic
- Refund checks will be mailed to the address on file. You can update your address in-person at the Office of Admissions and Records.
- Please refer to "Refund of Registration Fees" on page 9 in this schedule for eligibility requirements.
- Financial aid student refunds must be returned to the University to credit Federal financial aid accounts.



## Transportation and Parking Services

Transportation and Parking Services (TPS) is a division of the Public Safety Department (PSD). We are located within Lot A1 on University Drive.

### Hours of Operation

Monday – Thursday 8:00 a.m. – 6:30 p.m.  
Friday 8:00 a.m. – 5:00 p.m.

Public Safety Dispatcher is available until 11:00 p.m.

During the first two weeks of the semester or session the hours of operation for Monday through Thursday are extended until 7:30 p.m.

### Parking Enforcement

All permit and parking regulations are enforced seven days a week, 24 hours a day. Vehicles parked on campus are required to have a parking permit. There is no grace period and cars without permits will be ticketed.

### Shuttle Service

A shuttle service is available Monday through Friday, 7:00 a.m. to 10:30 p.m., and Saturday, 7:30 a.m. to 5:30 p.m. The cost of a transit card is **\$25 per semester**, with no cost during summer session. The shuttle operates from the following sites:

#### Oxnard

“C” Street Transfer Point (adjacent to the back of the Centerpoint Mall)  
“C” Street & Channel Islands Blvd.

#### Camarillo

Camarillo Metrolink Station  
Lewis Road & Ventura Blvd.

To utilize this service and purchase your photo transit card, stop by TPS to complete an application and have your photo taken. Please allow 10 minutes to process your card.

The transit card is a countywide bus pass that can be used with other area transits that transfer to the CSUCI shuttles or you can park at one of the sites and ride the shuttle to campus. Parking at the sites is free.

### Parking Permits

Semester and daily permits are valid in all “A” Lots.

#### Semester

Semester parking permits may be purchased from TPS. You will need your student ID and vehicle license plate numbers when purchasing your permit. You may pay with cash, credit card, or write a check payable to CSUCI. The cost of the permit is \$89.50\* per semester.

#### Daily

Daily parking permits may be purchased from either the “blue” permit dispensers located in Lots A1 and A2 or the lobby of the PSD; and are valid only on the date of purchase. The cost of the daily permit is \$4.00\*. The dispensers will accept coins, and \$1, \$5, \$10, and \$20 bills; and give change in one (1) dollar coins.

**\*Proposed fee increase is pending**

### Metered Parking

Metered spaces are available throughout the campus. These spaces are for individuals who have short-term University business (45 minutes or less). Meters are not to be used for class-instruction or while taking finals. Permits are not honored in metered spaces.

If you have additional questions or would like to receive a brochure of the parking regulations, contact TPS at (805) 437-8430, email [parking@csuci.edu](mailto:parking@csuci.edu), or visit the Website at [www.csuci.edu:16080/parking/](http://www.csuci.edu:16080/parking/).

### Federal Military Selective Service Act

The Federal Military Selective Service Act (the “Act”) requires most males residing in the United States to present themselves for registration with the Selective Service System within thirty days of their eighteenth birthday. Most males between the ages of 18 and 25 must be registered. Males born after December 31, 1959 may be required to submit a statement of compliance with the act and regulations in order to receive any grant, loan, or work assistance under specified provisions of existing federal law. In California, students subject to the Act who fail to register are also ineligible to receive any need-based student grants funded by the state or public postsecondary institution.

Selective Service registration forms are available at any U.S. Post Office, and many high schools have a staff member or teacher appointed as a Selective Service Registrar. Applicants for financial aid can also request that information provided on the Free Application for Federal Student Aid (FAFSA) be used to register them with the Selective Service. Information in the Selective Service System is available and the registration process may be initiated online at [www.sss.gov](http://www.sss.gov).





## Student Affairs

### Office of the Vice President for Student Affairs

Welcome to Cal State Channel Islands, the California State University system's 23rd campus. You have chosen an innovative institution designed specifically for the 21st century!

The Departments within the Division of Student Affairs will guide you as you matriculate through the university by providing quality services designed to enhance and complement your learning experience. The university encourages an environment where all students, regardless of their background, skill level or interests can exchange ideas and philosophies in a civil and collegial manner. We celebrate diversity at Cal State Channel Islands, as a source of renewal and vitality.

Although CSU Channel Islands is new to the Cal State system, our campus is already rich with history and tradition. What you achieve from CSU Channel Islands while you are with us is ultimately up to you! CSU Channel Islands is your opportunity to make a positive and creative contribution to the world by reaching out, and participating in an enriching and comprehensive university experience.

Once again, welcome to Cal State Channel Islands. Several years of planning have gone into creating this "new university," designed for the 21st century. Good luck as you embark upon your educational journey.



Wm. Gregory Sawyer, Ph.D.  
Vice President for the Division of Student Affairs

### Mission

The mission of the Division of Student Affairs is to promote and enrich students' education through a seamless learning environment that blurs the distinction between inside and outside classroom experiences. This is fostered through teaching, mentoring, advising, and counseling by way of ongoing direct contact with students in their every day lives. Student Affairs educates students in responsible community living, social intelligence, appreciation for the arts, leadership skills, ethical behavior, coping with adversity, health and wellness, valuing diversity, trusteeship, character development, problem-solving, responsible choices, and adaptive skills for living in an ever changing pluralistic society.

### Office of Student Development (OSD)

The Office of Student Development's mission is to provide programs and services that enhance the educational mission of the University and the Division of Student Affairs. This is accomplished through fostering a learning environment that promotes and embraces mentoring, diversity, leadership development, problem solving and decision making. To this end we assist students in developing a well balanced lifestyle that promotes awareness and improves the quality of life for all members of the Channel Islands campus. OSD encourages participative and cooperative teamwork, spiritual awareness, intellectual stimulation, character development, cultural diversity, physical health, and experiential leadership.

### New Student Orientation—"Island View Orientation"

All incoming students are requested to attend an orientation\* session. Due to the number of students attending orientation and the limited number of seats available only students with RSVPs will be reserved a seat at orientation.

Island View Orientations for fall 2002 are one-day sessions where you will have the opportunity to:

- Learn about academic requirements and policies
- Develop a class schedule with your academic advisor
- Register for classes
- Receive information regarding a variety of student support services (counseling, career, disability accommodations, etc.) and campus life (recreation, student life, clubs and organizations, etc.)
- Learn how to plan for the future you desire
- Attend informational sessions on financial aid & scholarships, technology and Police Services
- Receive your CSU Channel Islands student ID card, parking pass, etc.
- Tour the campus and learn necessary information about the library
- Prepare to start your fall semester well organized, informed and better prepared!

### Island View Orientation Schedule for Fall 2002

Friday	July 19	8:15 a.m. – 4:00 p.m.
Saturday	July 27	8:15 a.m. – 4:00 p.m.
Wednesday	July 31	8:15 a.m. – 4:00 p.m.
Saturday	August 10	8:15 a.m. – 4:00 p.m.
Tuesday	August 13	8:15 a.m. – 4:00 p.m.
Wednesday	August 21	12:30 p.m. – 8:00 p.m.

\*Students will receive an invitation and registration form for Island View Orientation after officially being admitted to the university.

### Student Activities

The OSD Programming Board (PB) is a group of students who assist the Office of Student Development in the creation and administration of a variety of activities and events on the CSU Channel Islands campus. The PB is comprised of seven areas that entertain, educate and enlighten CSU Channel Islands students through sponsored activities. Each program area has a chair who is responsible to plan, coordinate, promote, and implement the various programs. Program areas include: Cinema, Concerts, Cultural Arts, Promotions, Special Events, Speakers, Video Productions, and Comedy.

### Student Clubs and Organizations

Student organizations at Channel Islands play an important role in the university community. They increase the vitality of the campus as well as providing leadership opportunities and community service. Organizations at Cal State Channel Islands provide a variety of opportunities ranging from sports clubs to politics. The university gains directly by the quality of the organizations, their programs, the leadership training and the quality of students involved in the clubs.

### Student Leadership

Leadership development at Cal State Channel Islands is designed to assist students in reaching their most effective level of leadership by providing opportunities, resources and training. Leadership training at Cal State Channel Islands is designed to provide consultation on a variety of topics through the use of presentations and interactive and participative activities. The Office of Student Development is responsible for Annual Student Leadership Retreat. Programs that promote leadership skills and development include the fall and spring Leadership





Retreats. Workshops and seminars will be presented by the Student Life staff on the following topics:

- Conflict & Problem Solving
- Leadership Styles
- Conducting an Effective Meeting
- Developing a Team
- Motivation/Recruitment/Retention
- Creativity
- Conflict Resolution
- Diversity and Sensitivity Training
- Event Planning
- Fundraising
- Goal Setting
- Officer Transition
- Parliamentary Procedure
- Retreat Planning
- Time Management
- Effective Communication Skills
- Workshop Development
- Proper Fiscal Management

### **Recreation and Leisure Services**

Recreation and Leisure Services programs are sponsored by the Office of Student Development. These programs include recreational, leisure and wellness activities for all students. A variety of open recreational programs are available to students, including basketball, soccer, volleyball, softball, and hiking to name just a few.

Recreation and Leisure Services provides programming and activities in seven categories. The categories include: Informal Recreation, Intramural Sports, Sports Clubs, Health & Fitness, Outdoor Adventures, Instructional Programs and Special Events. The programming is structured to provide individual, dual and team competitions, workshops and instruction. This structure strives to provide a variety of recreational opportunities for a diverse student population.

#### **Informal Recreation**

This program provides an outlet for the entire university community to participate in a variety of sports. The Informal Program provides opportunities for individuals to participate at their leisure whether it be just shooting some hoops, playing in a small pickup game or working on skill development. The campus recreation areas will have specified hours designed for informal (open) play.

#### **Intramural Sports**

This program provides an outlet for the entire university community to join in on sport competition. The Intramural Sports Program provides a variety of structured sporting events to satisfy as many skill levels as possible. Scheduled tournaments, league play and challenges are offered. Opportunities include men's, women's and co-recreational play with appropriate rules presiding over each. Tournaments and/or leagues are offered in basketball, softball, volleyball, flag football, tennis, and golf.

#### **Sports Clubs**

The strength of the Sports Club program relies solely on the students. A sport club is a group of students voluntarily organized for the purpose of furthering their common interests in an activity through participation and/or competition. These interests may be competitive, recreational, instructional or a combination of these in nature. Clubs may represent the university in intercollegiate competition or conduct intracub activities such as practice, instruction, social and tournament

play. Sports clubs are designed to be a learning experience for the members through their involvement in fundraising, public relations, organization, administration, budgeting, marketing, management and scheduling, as well as the development of physical skills in the particular sport. Involvement in a group and team situation helps enhance the student's overall education while living in the university setting. Clubs may vary in focus and programming, even year to year, since the members are active participants in the leadership, responsibility and decision making process of the clubs' activities. Sport clubs are a great way for students to become involved in their campus community and make lasting relationships. All sports clubs must be registered with the Office of Student Life to be eligible for facility use and financial assistance at CSU Channel Islands.

#### **Health & Fitness**

The Fitness Center is home to the Health & Fitness component of RLS. The fitness area will provide opportunities to develop cardiovascular endurance, muscular strength, muscular endurance and flexibility. The cardiovascular amenities of the Fitness Center include: treadmills, stairclimbers, rowers, recumbent cycles, stationary cycles and elliptical trainers. The resistance training amenities include: selectorized stations, power cage, cable crossover, full selection of free weight benches, full selection of dumbbells from 2–120 pounds, and over 2,000 pounds of Olympic plates. The center also has stability balls, mats, jump ropes, and an aerobics program.

Trained student Fitness Instructors and Assistants staff the Fitness Center facility. Fitness Instructors and Assistants are certified in CPR and First Aid, as well as being trained in the principles of exercise, sports injury prevention, wellness, fitness assessment, and numerous components of pursuing a healthy lifestyle.

The facility is open for membership to students, faculty, staff and sponsored guests of CSUCI students, faculty and staff. Cardiovascular training, general conditioning, resistance training and flexibility programs are offered free of charge to members of the Fitness Center. All potential members of the facility must complete a Fitness Orientation prior to utilizing the facility.

#### **Outdoor Adventures**

Our Outdoor Adventures program couples sport-like activities with the aesthetic pleasures of the outdoors. Outdoor Adventures utilizes nature's resources (lakes, canals, mountains, rivers, and wilderness) to challenge the physical body as well the mind.

#### **Instructional Programs**

The Instructional programs offered by RLS provide learning opportunities for participants in such a way as to improve their skills and knowledge in order to enhance enjoyment relevant to sports participation. Clinics, workshops and skill sessions are used towards achieving this goal. Examples of instructional programs include dance, golf, martial arts, and tennis.

#### **Special Events**

The special events offered by RLS generally do not fit into another category or are a combination of categories of program offerings. These special events promote wellness through participation in the joys of recreation.

#### **Judicial Affairs**

The mission of Judicial Affairs is to develop, disseminate, interpret, and enforce campus regulations; to protect relevant legal rights of students; to address student behavioral problems in an effective and educational manner; to facilitate and encourage respect for campus

governance; and to provide learning experiences for students who participate in the operations of the judicial system. Judicial Affairs programs contribute to the teaching of appropriate individual and group behavior, as well as the protection of the campus community from disruption and harm. The programs are conducted in ways that serve to foster the ethical development and personal integrity of students and the promotion of an environment that is in accord with the overall educational goals of the University community.

## Financial Aid Office

### Mission

The Financial Aid Office is here to help students pursue their educational goals. Programs of Grants, Loans and Scholarships are available to help make college an affordable experience.

### Important Financial Aid Websites

Apply For Aid	<a href="http://www.fafsa.ed.gov">www.fafsa.ed.gov</a>
Federal Aid Programs	<a href="http://www.ed.gov/offices/OSFAP/Students">www.ed.gov/offices/OSFAP/Students</a>
State Grant Programs	<a href="http://www.csac.ca.gov">www.csac.ca.gov</a>
State Loan Programs	<a href="http://www.edfund.org">www.edfund.org</a>

### Office of Career, Health, Accommodations, Personal Counseling Services (C.H.A.Ps)

C.H.A.Ps stands for Career, Health, Accommodations, and Personal Counseling Services. C.H.A.Ps is more than a collection of services. It is a team of service professionals working together to help students meet the challenges of college life. The team includes: Career Counselors, Health and Wellness Experts, Disabilities Accommodations Specialists, Counseling Psychologists

The C.H.A.Ps Program supports the mission of the Division of Student Affairs in its commitment to promote and enrich the student's education. C.H.A.Ps carries out this mission by providing quality student services that foster the continuous improvement and ongoing development of students inside and outside of the classroom. It accomplishes this mission by:

- Providing comprehensive career development services to help students integrate their educational experiences with lifelong learning and career opportunities through effective academic/career decision-making, planning, and job search.
- Improving student achievement by identifying and reducing health barriers to learning through student health promotion and disease and injury prevention.
- Assisting students with disabilities to realize their academic and personal potential through quality student services that comply with Section 504 of the Federal Rehabilitation Act of 1973 and the American with Disabilities Act (ADA) of 1990.
- Providing counseling services that facilitate the social-emotional adjustment of students who experience life challenges that interfere with personal growth and adjustment to university life.

Our Career Services can help students:

- Explore their personal interests, values, and goals
- Discover where they want to go with their career
- Plan how to get there

## Health and Wellness

Students can expect assistance with:

- Diagnosis and Treatment of Acute Illness and Injuries
- Physical Examinations
- Family Planning
- Immunizations (Measles and Rubella)
- Testing Services
- STD Screening and Treatment
- Emergency Care
- Student Health Insurance
- Health Education Program
- Student Health Advisory Board

## Accommodations Services

Students can get assistance with:

- Completing University admission applications
- Student Orientation
- Priority registration
- Program change assistance
- Disability parking
- Referral to on- and off-campus resources
- Disability management counseling
- Special test-taking accommodations
- Notetakers
- Readers
- Interpreters (sign language)
- Computer access and training services to introduce students with disabilities to computers and specialized assistive technologies

## Personal Counseling and Testing

Student can receive assistance with matters related to:

- Life Crisis
- Assertiveness Skills
- Procrastination
- Anger Management
- Self-esteem Issues
- Personal Counseling
- Relationships
- Racial/Cultural Issues
- Academic and Psychological Testing
- Long-term Counseling referral





## Fall 2002 Course Offerings

### Course Numbering

100 – 299	Lower-Division Courses
300 – 499	Upper-Division Courses
500 – 599	Graduate and Teacher Credential Courses
330 – 349	Interdisciplinary Courses- without prerequisites (including cross-listed courses)
430 – 449	Interdisciplinary Courses- may have prerequisites or require permission from the instructor (including cross-listed courses)
397	Directed Studies Course- variable topic/credit courses
490	Special Topics- variable topic/credit courses
492	Service Learning/ Internship Course- variable credit
494	Independent Research Course- variable credit
497	Directed Studies Course- variable topic/credit courses
498	Senior Thesis Course- variable topic/credit courses
499	Undergraduate Capstone Course

### General Education

Please obtain an updated General Education listing from the Academic Advising Center.

## Art

### BACHELOR OF ARTS IN ART

Minor in Art

<b>ART 108</b> <b>49050</b>	<b>VISUAL TECHNOLOGY (3)</b> Monday/Wednesday, 8:00-9:50 a.m. <b>Lab fee \$15</b>
<b>ART 204</b> <b>49051</b>	<b>GRAPHIC DESIGN (3)</b> Tuesday/Thursday, 7:00-9:50 p.m. <b>Lab fee \$15</b>
<b>ART 205</b> <b>49052</b>	<b>MULTIMEDIA (3)</b> Tuesday/Thursday, 4:00-6:50 p.m. <b>Lab fee \$15</b>
<b>ART 206</b> <b>49053</b>	<b>ANIMATION (3)</b> Monday/Wednesday, 4:00-6:50 p.m. <b>Lab fee \$15</b>
<b>ART 310</b> <b>49054</b>	<b>TWO-DIMENSIONAL MEDIA AND PROCESSES (3)</b> Monday/Wednesday, 10:00-12:50 p.m. <b>Lab fee \$15</b>
<b>ART 311</b> <b>49055</b>	<b>THREE-DIMENSIONAL MEDIA AND PROCESSES (3)</b> Tuesday/Thursday, 10:00-12:50 p.m. <b>Lab fee \$15</b>

<b>ART 312</b> <b>49056</b>	<b>TIME-BASED DIGITAL MEDIA AND PROCESSES (3)</b> Monday/Wednesday, 1:00-3:50 p.m. <b>Lab fee \$15</b>
<b>ART 313</b> <b>49057</b>	<b>COMMUNICATION DESIGN TECHNOLOGY MEDIA AND PROCESSES (3)</b> Tuesday/Thursday, 1:00-3:50 p.m. <b>Lab fee \$15</b>
<b>ART 330</b> <b>49058</b>	<b>CRITICAL THINKING IN A VISUAL WORLD (3)</b> Monday/Wednesday, 11:00-12:20 p.m.
<b>ART 331</b> <b>49060</b> <b>49059</b>	<b>ART AND MASS MEDIA (3)</b> Monday, 7:00-9:50 p.m. Tuesday/Thursday, 9:30-10:50 a.m.
<b>ART 332</b> <b>49061</b>	<b>MULTICULTURAL ART MOVEMENTS (3)</b> Wednesday, 7:00-9:50 p.m.
<b>ART 431</b> <b>49062</b>	<b>EUROPEAN RENAISSANCE LITERATURE AND ART (3)</b> Wednesday, 1:00-3:50 p.m. Also listed as ENGL 431.

## Biology

### BACHELOR OF SCIENCE IN BIOLOGY

General Biology

Emphasis in Cell and Molecular Biology

Minor in Biology

<b>BIOL 200</b> <b>49150</b> <b>BIOL 200L</b>	<b>PRINCIPLES OF ORGANISMAL AND POPULATION BIOLOGY (3)</b> Tuesday/Thursday, 7:00-8:20 p.m. <b>PRINCIPLES OF ORGANISMAL AND POPULATION BIOLOGY LAB (Must be taken concurrently with BIOL 200) (1)</b>
<b>49152</b> <b>49151</b>	Monday, 1:00-3:50 p.m. Monday, 5:00-7:50 p.m. <b>Lab fee: \$40</b>
<b>BIOL 201</b> <b>49153</b> <b>BIOL 201L</b>	<b>PRINCIPLES OF CELL AND MOLECULAR BIOLOGY (3)</b> Tuesday/Thursday, 1:00-2:20 p.m. <b>PRINCIPLES OF CELL AND MOLECULAR BIOLOGY LAB (Must be taken concurrently with BIOL 201) (1)</b>
<b>49154</b>	Friday, 10:00-12:50 p.m. <b>Lab fee \$40</b>
<b>BIOL 202</b> <b>49155</b> <b>49156</b>	<b>BIOSTATISTICS (3)</b> Monday/Wednesday, 4:00-5:20 p.m. Tuesday/Thursday, 9:30-10:50 a.m. Also listed as MATH 202. <b>Lab fee \$25</b>

- BIOL 300 CELL PHYSIOLOGY (3)**  
**49157** Tuesday/Thursday, 11:00-12:20 p.m.  
**BIOL 300L CELL PHYSIOLOGY LAB (Must be taken concurrently with BIOL 300) (1)**  
**49158** Tuesday, 1:00-3:50 p.m.  
**49159** Wednesday, 1:00-3:50 p.m.  
**49160** Thursday, 1:00-3:50 p.m.  
**Lab Fee: \$40**
- BIOL 302 GENETICS AND EVOLUTION (3)**  
**49161** Monday/Wednesday, 11:00-12:20 p.m.
- BIOL 330 ECOLOGY AND THE ENVIRONMENT (3)**  
**49162** Tuesday/Thursday, 9:00-10:20 a.m.  
**BIOL 330L ECOLOGY AND THE ENVIRONMENT LAB (Must be taken concurrently with BIOL 330) (1)**  
**49163** Tuesday, 1:00-3:50 p.m.  
**49164** Wednesday, 1:00-3:50 p.m.  
**49165** Thursday, 1:00-3:50 p.m.  
 Also listed as ANTH 330.  
**Lab Fee: \$40**
- BIOL 410 COMPUTER APPLICATIONS IN BIOMEDICAL FIELDS (3)**  
**49168** Monday/Friday, 1:00-2:20 p.m.  
 Also listed as COMP 410.  
**Lab Fee: \$40**
- CHEM 311 ORGANIC CHEMISTRY I (3)**  
**49254** Monday/Wednesday/Friday, 10:00-10:50 a.m.
- CHEM 312 ORGANIC CHEMISTRY I LAB (1)**  
**49255** Monday, 1:00-3:50 p.m.  
**49256** Wednesday, 1:00-3:50 p.m.  
**49257** Saturday, 9:00-11:50 a.m.  
**49258** Saturday, 1:00-3:50 p.m.  
**Lab Fee: \$25, and \$25 refundable breakage card fee.**
- CHEM 313 ORGANIC CHEMISTRY I LEARNING COMMUNITY (1)**  
**49259** Monday, 1:00-1:50 p.m.  
**49260** Friday, 1:00-1:50 p.m.
- MATH 150 CALCULUS I (4)**  
**49601** Tuesday/Thursday, 4:00-5:50 p.m.  
**Lab Fee: \$25**
- MGT 346 SCIENTIFIC AND PROFESSIONAL ETHICS (3)**  
**49679** Monday/Wednesday, 1:00-2:20 p.m.  
**49678** Wednesday, 4:00-6:50 p.m.  
 Also listed as BIOL 346, CHEM 346, MATH 346.
- PHYS 200 GENERAL PHYSICS I (3)**  
**49750** Tuesday/Thursday, 1:00-2:20 p.m.  
**PHYS 200L GENERAL PHYSICS I LAB (Must be taken concurrently with PHYS 200) (1)**  
**49751** Tuesday/Thursday, 2:30-3:50 p.m.  
**Lab Fee: \$25**

## Business

### BACHELOR OF SCIENCE IN BUSINESS

Option in Management

Minor in Business Management

Minor in Economics

- ACCT 300 APPLIED MANAGERIAL ACCOUNTING (3)**  
**49000** Monday/Wednesday, 11:00-12:20 p.m.  
**49001** Tuesday, 7:00-9:50 p.m.
- BUS 340 BUSINESS AND MONEY IN THE AMERICAN NOVEL (3)**  
**49200** Monday/Wednesday, 1:00-2:20 p.m.  
 Also listed as ENGL 340, ECON 340.
- BUS 341 DRUG DISCOVERY AND DEVELOPMENT (3)**  
**49201** Tuesday/Thursday, 12:00-1:20 p.m.  
 Also listed as CHEM 341, ECON 341.
- BUS 424 BUSINESS IN ITS SOCIAL SETTING (3)**  
**49203** Thursday, 7:00-9:50 p.m.
- CIS 310 MANAGEMENT INFORMATION SYSTEMS (3)**  
**49300** Tuesday/Thursday, 2:00-3:50 p.m.  
**49301** Thursday, 4:00-6:50 p.m.
- ECON 300 FUNDAMENTALS OF ECONOMICS (3)**  
**49400** Tuesday/Thursday, 1:00-2:20 p.m.
- ECON 310 INTERMEDIATE MICROECONOMICS (3)**  
**49402** Tuesday/Thursday, 11:00-12:20 p.m.
- ECON 320 MONEY AND BANKING (3)**  
**49403** Wednesday, 4:00-6:50 p.m.
- ECON 329 MANAGERIAL ECONOMICS (3)**  
**49404** Friday, 9:00-11:50 a.m.
- ECON 343 CAPITAL THEORY (3)**  
**49405** Monday/Wednesday, 4:00-5:20 p.m.  
 Also listed as FIN 343.
- ENGL 330 WRITING IN THE DISCIPLINES (3)**  
**49550** Monday/Wednesday/Friday, 10:00-10:50 a.m.  
**49551** Tuesday, 4:00-6:50 p.m.
- ENGL 483 TECHNICAL VISUAL COMMUNICATION (3)**  
**49570** Monday, 7:00-9:50 p.m.  
**49569** Thursday, 9:30-12:20 p.m.
- FIN 300 BUSINESS FINANCE (3)**  
**49650** Tuesday/Thursday, 1:00-2:20 p.m.  
**49651** Wednesday, 7:00-9:50 p.m.
- MATH 140 CALCULUS FOR BUSINESS APPLICATIONS I (3)**  
**49600** Tuesday/Thursday, 3:00-4:20 p.m.  
**Lab fee: \$25**



**MATH 340 STATISTICS FOR BUSINESS AND ECONOMICS (3)**

**49609** Monday/Wednesday, 1:00-2:20 p.m.

**49610** Monday/Wednesday, 3:00-4:20 p.m.

**49611** Tuesday/Thursday, 5:30-6:50 p.m.

**Lab fee: \$25**

**MGT 307 MANAGEMENT OF ORGANIZATIONS (3)**

**49675** Monday/Wednesday, 1:00-2:20 p.m.

**49676** Tuesday, 4:00-6:50 p.m.

**MGT 310 MANAGEMENT OF INTERNATIONAL BUSINESS (3)**

**49677** Thursday, 7:00-9:50 p.m.

**MGT 346 SCIENTIFIC AND PROFESSIONAL ETHICS (3)**

**49679** Monday/Wednesday, 1:00-2:20 p.m.

**49678** Wednesday, 4:00-6:50 p.m.

Also listed as BIOL 346, CHEM 346, MATH 346.

**MKT 310 PRINCIPLES OF MARKETING (3)**

**49700** Tuesday/Thursday, 9:30-10:50 a.m.

**49701** Wednesday, 7:00-9:50 p.m.

**ENGL 482 TECHNICAL WRITING (3)**

**49568** Tuesday, 9:30-12:20 p.m.

**MATH 150 CALCULUS I (4)**

**49601** Tuesday/Thursday, 4:00-5:50 p.m.

**Lab fee: \$25**

**MATH 230 LOGIC (3)**

**49606** Monday/Wednesday, 8:30-9:50 a.m.

**MATH 240 INTRODUCTION TO LINEAR ALGEBRA (3)**

**49607** Monday/Wednesday/Friday, 2:00-2:50 p.m.

**Lab fee: \$25**

**MATH 300 DISCRETE MATHEMATICS (3)**

**49608** Monday/Wednesday/Friday, 1:00-1:50 p.m.

**PHYS 200 GENERAL PHYSICS I (3)**

**49750** Tuesday/Thursday, 1:00-2:20 p.m.

**PHYS 200L GENERAL PHYSICS I LAB (Must be taken concurrently with PHYS 200) (1)**

**49751** Tuesday/Thursday, 2:30-3:50 p.m.

**Lab fee: \$25**

## Computer Science

**BACHELOR OF SCIENCE IN COMPUTER SCIENCE**

Minor in Computer Science

**COMP 150 OBJECT ORIENTED PROGRAMMING (4)**

**49351** Monday/Wednesday, 10:00-10:50 a.m. and Friday, 9:00-10:50 a.m.

**49352** Monday/Wednesday, 4:00-5:50 p.m.

**Lab Fee: \$40**

**COMP 151 DATA STRUCTURES (4)**

**49353** Monday/Wednesday, 3:00-3:50 p.m. and Friday, 3:00-4:50 p.m.

**Lab fee: \$40**

**COMP 162 COMPUTER ARCHITECTURE AND ASSEMBLY LANGUAGE (3)**

**49354** Monday/Wednesday/Friday, 12:00-12:50 p.m.

**Lab fee: \$40**

**COMP 232 PROGRAMMING LANGUAGES (3)**

**49355** Tuesday/Thursday, 12:30-1:50 p.m.

**Lab fee: \$40**

**COMP 410 COMPUTER APPLICATIONS IN BIOMEDICAL FIELDS (3)**

**49356** Monday/Friday, 1:00-2:20 p.m.

Also listed as BIOL 410.

**Lab fee: \$40**

**COMP 492 INTERNSHIP (3)**

**49357** TBA

**COMP 497 DIRECTED STUDY (3)**

**49358** TBA

## English

**BACHELOR OF ARTS IN ENGLISH**

Bachelor of Arts in English with an emphasis in Creative Writing

Bachelor of Arts in English with an emphasis in Multicultural Literature

Minor in English

Certificate in Technical Writing

**ENGL 310 RESEARCH METHODS (3)**

**49552** Monday/Wednesday/Friday, 9:00-9:50 a.m.

**49553** Tuesday/Thursday, 2:00-3:20 p.m.

**ENGL 312 CHILDREN'S LITERATURE (3)**

**49554** Monday/Wednesday/Friday, 10:00-10:50 a.m.

**49555** Tuesday/Thursday, 2:00-3:20 p.m.

**ENGL 315 LINGUISTICS (3)**

**49556** Monday, 4:00-6:50 p.m.

**49557** Tuesday/Thursday, 5:30-6:50 p.m.

**ENGL 326 MAJOR BRITISH AUTHORS (3)**

**49558** Tuesday/Thursday, 10:00-11:20 a.m.

**ENGL 330 WRITING IN THE DISCIPLINES (3)**

**49550** Monday/Wednesday/Friday, 10:00-10:50 a.m.

**49551** Tuesday, 4:00-6:50 p.m.

**ENGL 337 LITERATURE OF THE ENVIRONMENT (3)**

**49560** Monday/Wednesday/Friday, 3:00-3:50 p.m.

**ENGL 340 BUSINESS AND MONEY IN THE AMERICAN NOVEL (3)**

**49561** Monday/Wednesday, 1:00-2:20 p.m.

Also listed as BUS 340, ECON 340.



**ENGL 431 EUROPEAN RENAISSANCE LITERATURE AND ART (3)**

**49562** Wednesday, 1:00-3:50 p.m.  
Also listed as ART 431.

**ENGL 449 MULTICULTURAL LITERATURE (3)**

**49563** Wednesday, 4:00-6:50 p.m.

**ENGL 460 PERSPECTIVES IN CREATIVE WRITING (3)**

**49564** Tuesday/Thursday, 1:00-2:20 p.m.

**ENGL 475 LANGUAGE IN SOCIAL CONTEXT (3)**

**49567** Monday, 9:00-11:50 a.m.

**49565** Tuesday, 4:00-6:50 p.m.

**49566** Thursday, 4:00-6:50 p.m.

**ENGL 482 TECHNICAL WRITING (3)**

**49568** Tuesday, 9:30-12:20 p.m.

**ENGL 483 TECHNICAL VISUAL COMMUNICATION (3)**

**49570** Monday, 7:00-9:50 p.m.

**49569** Thursday, 9:30-12:20 a.m.

**TH 333 MULTICULTURAL DRAMA IN PERFORMANCE/ PRODUCTION (3)**

**49860** Tuesday, 7:00-9:50 p.m.

Also listed as ENGL 333.

## Environmental Science and Resource Management

### BACHELOR OF SCIENCE IN ENVIRONMENTAL SCIENCE AND RESOURCE MANAGEMENT

Emphasis in Environmental Science

Emphasis in Resource Management

**BIOL 201 PRINCIPLES OF CELL AND MOLECULAR BIOLOGY (3)**

**49153** Tuesday/Thursday, 1:00-2:20 p.m.

**BIOL 201L PRINCIPLES OF CELL AND MOLECULAR BIOLOGY LAB (Must be taken concurrently with BIOL 201) (1)**

**49154** Friday, 10:00-12:50 p.m.

**Lab fee: \$40**

**BIOL 202 BIOSTATISTICS (3)**

**49155** Monday/Wednesday, 4:00-5:20 p.m.

**49156** Tuesday/Thursday, 9:30-10:50 a.m.

Also listed as MATH 202.

**Lab fee: \$25**

**BIOL 330 ECOLOGY AND THE ENVIRONMENT (3)**

**49162** Tuesday/Thursday, 9:00-10:20 a.m.

**BIOL 330L ECOLOGY AND THE ENVIRONMENT LAB (Must be taken concurrently with BIOL 330) (1)**

**49163** Tuesday, 1:00-3:50 p.m.

**49164** Wednesday, 1:00-3:50 p.m.

**49165** Thursday, 1:00-3:50 p.m.

Also listed as ANTH 330.

**Lab fee: \$40**

**CHEM 311 ORGANIC CHEMISTRY I (3)**

**49254** Monday/Wednesday/Friday, 10:00-10:50 a.m.

**CHEM 312 ORGANIC CHEMISTRY I LAB (1)**

**49255** Monday, 1:00-3:50 p.m.

**49256** Wednesday, 1:00-3:50 p.m.

**49257** Saturday, 9:00-11:50 a.m.

**49258** Saturday, 1:00-3:50 p.m.

**Lab Fee: \$25, and \$25 refundable breakage card fee.**

**ECON 310 INTERMEDIATE MICROECONOMICS (3)**

**49402** Tuesday/Thursday, 11:00-12:20 p.m.

**ECON 329 MANAGERIAL ECONOMICS (3)**

**49404** Friday, 9:00-11:50 a.m.

**ECON 343 CAPITAL THEORY (3)**

**49405** Monday/Wednesday, 4:00-5:20 p.m.

Also listed as FIN 343.

**ECON 362 INTRODUCTION TO ENVIRONMENTAL ECONOMICS (3)**

**49401** Tuesday/Thursday, 2:30-3:50 p.m.

**ENGL 330 WRITING IN THE DISCIPLINES (3)**

**49550** Monday/Wednesday/Friday, 10:00-10:50 a.m.

**49551** Tuesday, 4:00-6:50 p.m.

**ENGL 337 LITERATURE OF THE ENVIRONMENT (3)**

**49560** Monday/Wednesday/Friday, 3:00-3:50 p.m.

**ESRM 330 ENVIRONMENTAL INSTITUTIONS, LAW AND REGULATION (3)**

**49630** Tuesday/Thursday, 4:00-5:20 p.m.

**GEOL 321 ENVIRONMENTAL GEOLOGY (3)**

**49575** Tuesday/Thursday, 10:30-11:50 p.m.

**MATH 340 STATISTICS FOR BUSINESS AND ECONOMICS (3)**

**49609** Monday/Wednesday, 1:00-2:20 p.m.

**49610** Monday/Wednesday, 3:00-4:20 p.m.

**49611** Tuesday/Thursday, 5:30-6:50 p.m.

**Lab fee: \$25**

**MGT 307 MANAGEMENT OF ORGANIZATIONS (3)**

**49675** Monday/Wednesday, 1:00-2:20 p.m.

**49676** Tuesday, 4:00-6:50 p.m.

**PHYS 200 GENERAL PHYSICS I (3)**

**49750** Tuesday/Thursday, 1:00-2:20 p.m.

**PHYS 200L GENERAL PHYSICS I LAB (Must be taken concurrently with PHYS 200) (1)**

**49751** Tuesday/Thursday, 2:30-3:50 p.m.

**Lab fee: \$25**



## Liberal Studies (Interdisciplinary Option)

### BACHELOR OF ARTS IN LIBERAL STUDIES (INTERDISCIPLINARY OPTION)

- ANTH 345 BIOANTHROPOLOGY (3)**  
**49100** Tuesday, 7:00-9:50 p.m.
- ART 330 CRITICAL THINKING IN A VISUAL WORLD (3)**  
**49058** Monday/Wednesday, 11:00-12:20 p.m.
- ART 331 ART AND MASS MEDIA (3)**  
**49060** Monday, 7:00-9:50 p.m.  
**49059** Tuesday/Thursday, 9:30-10:50 a.m.
- ART 332 MULTICULTURAL ART MOVEMENTS (3)**  
**49061** Wednesday, 7:00-9:50 p.m.
- BIOL 330 ECOLOGY AND THE ENVIRONMENT (3)**  
**49162** Tuesday/Thursday, 9:00-10:20 a.m.
- BIOL 330L ECOLOGY AND THE ENVIRONMENT LAB (Must be taken concurrently with BIOL 330) (1)**  
**49163** Tuesday, 1:00-3:50 p.m.  
**49164** Wednesday, 1:00-3:50 p.m.  
**49165** Thursday, 1:00-3:50 p.m.  
Also listed as ANTH 330.  
**Lab fee: \$40**
- CHEM 341 DRUG DISCOVERY AND DEVELOPMENT (3)**  
**49261** Tuesday/Thursday, 12:00-1:20 p.m.  
Also listed as BUS 341, ECON 341.
- COMP 101 COMPUTER LITERACY (3)**  
**49350** Tuesday/Thursday, 11:00-12:20 p.m.  
**Lab fee: \$40**
- ECON 343 CAPITAL THEORY (3)**  
**49405** Monday/Wednesday, 4:00-5:20 p.m.  
Also listed as FIN 343
- ENGL 330 WRITING IN THE DISCIPLINES (3)**  
**49550** Monday/Wednesday/Friday, 10:00-10:50 a.m.  
**49551** Tuesday, 4:00-6:50 p.m.
- ENGL 337 LITERATURE OF THE ENVIRONMENT (3)**  
**49560** Monday/Wednesday/Friday, 3:00-3:50 p.m.
- ENGL 340 BUSINESS AND MONEY IN THE AMERICAN NOVEL (3)**  
**49561** Monday/Wednesday, 1:00-2:20 p.m.  
Also listed as BUS 340, ECON 340.
- ENGL 431 EUROPEAN RENAISSANCE LITERATURE AND ART (3)**  
**49562** Wednesday, 1:00-3:50 p.m.  
Also listed as: ART 431.
- ENGL 449 MULTICULTURAL LITERATURE (3)**  
**49563** Wednesday, 4:00-6:50 p.m.

### ESRM 330 ENVIRONMENTAL INSTITUTIONS, LAW AND REGULATION (3)

**49630** Tuesday/Thursday, 4:00-5:20 p.m.

### MATH 340 STATISTICS FOR BUSINESS (3)

**49609** Monday/Wednesday, 1:00-2:20 p.m.

**49610** Monday/Wednesday, 3:00-4:20 p.m.

**49611** Tuesday/Thursday, 5:30-6:50 p.m.

**Lab fee: \$25**

### MATH 342 PROBABILITY AND STATISTICS (3)

**49612** Monday/Wednesday/Friday, 11:00-11:50 a.m.

**Lab fee: \$25**

### MGT 346 SCIENTIFIC AND PROFESSIONAL ETHICS (3)

**49679** Monday/Wednesday, 1:00-2:20 p.m.

**49678** Wednesday, 4:00-6:50 p.m.

Also listed as BIOL 346, CHEM 346, MATH 346.

### PSY 333 MEASUREMENT AND TESTING (3)

**49780** Tuesday/Thursday, 9:30-10:50 a.m.

### SPED 345 INDIVIDUALS WITH DISABILITIES (3)

**49800** Monday, 4:00-6:50 p.m.

**49801** Tuesday, 1:00-3:50 p.m.

**49802** Wednesday, 9:00-11:50 p.m.

## Liberal Studies (Teaching and Learning Option)

### BACHELOR OF ARTS IN LIBERAL STUDIES (TEACHING AND LEARNING OPTION)

#### BIOL 200 PRINCIPLES OF ORGANISMAL AND POPULATION BIOLOGY (3)

**49150** Tuesday/Thursday, 7:00-8:20 p.m.

Note: BIOL 200, NOT BIOL 201 required for Liberal Studies, Teaching and Learning Option.

#### BIOL 200L PRINCIPLES OF ORGANISMAL AND POPULATION BIOLOGY LAB (Must be taken concurrently with BIOL 200) (1)

**49152** Monday, 1:00-3:50 p.m.

**49151** Monday, 5:00-7:50 p.m.

**Lab fee: \$40**

#### CHEM 170 PHYSICAL SCIENCES FOR THE ELEMENTARY SCHOOL TEACHER (4)

**49252** Monday/Wednesday, 1:00-3:50 p.m.

**49253** Tuesday/Thursday, 4:00-6:50 p.m.

**Lab fee: \$15**

#### COMP 101 COMPUTER LITERACY (3)

**49350** Tuesday/Thursday, 11:00-12:20 p.m.

**Lab fee: \$40**

#### ECON 300 FUNDAMENTALS OF ECONOMICS (3)

**49400** Tuesday/Thursday 1:00-2:20 p.m.

#### EDUC 320 EDUCATION IN MODERN SOCIETY (3)

**49509** Monday/Wednesday/Friday, 11:00-11:50 a.m.

**49510** Wednesday, 4:00-6:50 p.m.



<b>ENGL 312</b>	<b>CHILDREN'S LITERATURE (3)</b>
<b>49554</b>	Monday/Wednesday/Friday, 10:00-10:50 a.m.
<b>49555</b>	Tuesday/Thursday, 2:00-3:20 p.m.
<b>ENGL 315</b>	<b>LINGUISTICS (3)</b>
<b>49556</b>	Monday, 4:00-6:50 p.m.
<b>49557</b>	Tuesday/Thursday, 5:30-6:50 p.m.
<b>ENGL 475</b>	<b>LANGUAGE IN SOCIAL CONTEXT (3)</b>
<b>49567</b>	Monday, 9:00-11:50 a.m.
<b>49565</b>	Tuesday, 4:00-6:50 p.m.
<b>49566</b>	Thursday, 4:00-6:50 p.m.
<b>HIST 350</b>	<b>CHICANO HISTORY AND CULTURE (3)</b>
<b>49576</b>	Thursday, 7:00-9:50 p.m.
<b>HIST 365</b>	<b>THEMES IN WORLD CIVILIZATION BEFORE 1500 (3)</b>
<b>49577</b>	Tuesday, 9:00-11:50 a.m.
<b>HIST 366</b>	<b>THEMES IN WORLD CIVILIZATION SINCE 1500 (3)</b>
<b>49578</b>	Monday, 7:00-9:50 p.m.
<b>HIST 369</b>	<b>CALIFORNIA HISTORY AND CULTURE (3)</b>
<b>49579</b>	Wednesday, 7:00-9:50 p.m.
<b>MATH 208</b>	<b>MODERN MATHEMATICS FOR ELEMENTARY SCHOOL TEACHERS (3)</b>
<b>49605</b>	Monday/Wednesday/Friday, 12:00-12:50 p.m.
<b>49604</b>	Monday/Wednesday/Friday, 3:00-3:50 p.m.
	<b>Lab fee: \$25</b>
<b>PHED 302</b>	<b>MOTOR LEARNING FITNESS (3)</b>
<b>49730</b>	Monday/Wednesday/Friday, 9:00-9:50 a.m.
<b>49731</b>	Tuesday/Thursday, 4:00-5:20 p.m.
<b>PSY 333</b>	<b>MEASUREMENT AND TESTING OF GROUPS AND INDIVIDUALS (3)</b>
<b>49780</b>	Tuesday/Thursday, 9:30-10:50 a.m.
<b>PSY 344</b>	<b>PSYCHOLOGY AND TRADITIONAL ASIAN THOUGHT (3)</b>
<b>49781</b>	Monday, 1:00-3:50 p.m.
<b>PSY 350</b>	<b>CLINICAL AND COUNSELING PSYCHOLOGY (3)</b>
<b>49782</b>	Tuesday, 7:00-9:50 p.m.
<b>PSY 461</b>	<b>TOPICS IN CHILD AND ADOLESCENT DEVELOPMENT (3)</b>
<b>49783</b>	Tuesday/Thursday 1:00-2:20 p.m.
<b>SPED 345</b>	<b>INDIVIDUALS WITH DISABILITIES (3)</b>
<b>49800</b>	Monday, 4:00-6:50 p.m.
<b>49801</b>	Tuesday, 1:00-3:50 p.m.
<b>49802</b>	Wednesday, 9:00-11:50 a.m.
<b>TH 333</b>	<b>MULTICULTURAL DRAMA IN PERFORMANCE/ PRODUCTION (3)</b>
<b>49860</b>	Tuesday, 7:00-9:50 p.m.
	Also listed as ENGL 333.

## Liberal Studies (Concentrated Studies Option)

The Concentrated Studies option gives students the opportunity to study in-depth with a specific faculty member. This option will appeal to students who want greater flexibility in designing their course of study, who need flexibility in order to complete their degree, or who wish to investigate an academic area before selecting a major. The Concentrated Studies Option requires 21 hours in an approved concentration. Contact the Liberal Studies advisor for additional information.

## Mathematics

### BACHELOR OF SCIENCE IN MATHEMATICS

Minor in Mathematics

#### COMP 150 OBJECT ORIENTED PROGRAMMING (4)

**49351** Monday/Wednesday, 10:00-10:50 a.m. and Friday, 9:00-10:50 a.m.

**49352** Monday/Wednesday, 4:00-5:50 p.m.

**Lab Fee: \$40**

#### MATH 150 CALCULUS I (4)

**49601** Tuesday/Thursday, 4:00-5:50 p.m.

**Lab Fee \$25**

#### MATH 230 LOGIC (3)

**49606** Monday/Wednesday, 8:30-9:50 a.m.

#### MATH 240 INTRO TO LINEAR ALGEBRA (3)

**49607** Monday/Wednesday/Friday, 2:00-2:50 p.m.

**Lab Fee \$25**

#### MATH 300 DISCRETE MATH (3)

**49608** Monday/Wednesday/Friday, 1:00-1:50 p.m.

#### MATH 342 PROBABILITY AND STATISTICS (3)

**49162** Monday/Wednesday/Friday, 11:00-11:50 p.m.

**Lab Fee \$25**

#### MATH 492 INTERNSHIP (3)

**49615** TBA

#### MATH 497 DIRECTED STUDY (3)

**49616** TBA

#### PHYS 200 GENERAL PHYSICS I (3)

**49750** Tuesday/Thursday 1:00-2:20 p.m.

**PHYS 200L GENERAL PHYSICS I LAB (Must be taken concurrently with PHYS 200) (1)**

**49751** Tuesday/Thursday, 2:30-3:50 p.m.

**Lab Fee \$25**



## Multiple Subjects Teaching Credential

### MULTIPLE SUBJECTS TEACHING CREDENTIAL

**EDUC 510 LEARNING THEORY AND DEVELOPMENT APPLIED IN MULTICULTURAL EDUCATION CONTEXTS (3)****49500** Wednesday, 1:00-3:50 p.m.**49501** Thursday, 4:00-6:50 p.m.**EDUC 512 EQUITY, DIVERSITY AND FOUNDATIONS OF SCHOOLING (3)****49503** Wednesday, 4:00-6:50 p.m.**49502** Thursday, 1:00-3:50 p.m.**EDUC 520 OBSERVING AND GUIDING BEHAVIOR IN MULTILINGUAL/MULTICULTURAL AND INCLUSIVE CLASSROOMS (3)****49504** Monday, 1:00-3:50 p.m.**49505** Tuesday, 4:00-6:50 p.m.

Prerequisites: Students must register for at least one unit of Field Experience (EDUC 560) concurrent with this course.

**ENGL 475 LANGUAGE IN SOCIAL CONTEXT (3)****49567** Monday, 9:00-11:50 a.m.**49565** Tuesday, 4:00-6:50 p.m.**49566** Thursday, 4:00-6:50 p.m.**SPED 345 INDIVIDUALS WITH DISABILITIES (3)****49800** Monday, 4:00-6:50 p.m.**49801** Tuesday, 1:00-3:50 p.m.**49802** Wednesday, 9:00-11:50 a.m.

### FULL TIME MULTIPLE SUBJECT COHORT

**EDMS 522 LITERACY I / MULTICULTURAL-MULTILINGUAL (3)****R** Weeks 1-8 and 14-16: Monday, 9:00-11:50 a.m., and Weeks 9-13: Monday, 9:00-10:50 a.m.

Prerequisite: Must be officially admitted to the Multiple Subjects Credential Program. Students must register for at least 5 units of Field Experience (EDUC 560) concurrent with this course.

**EDMS 526 MODERN METHODS IN MATHEMATICS TEACHING (3)****R** Weeks 1-8 and 14-16: Wednesday, 9:00-11:50 a.m., and Weeks 9-13: Monday, 11:00-12:50 p.m.

Prerequisite: Must be officially admitted to the Multiple Subjects Credential Program. Students must register for at least 5 units of Field Experience (EDUC 560) concurrent with this course.

**EDMS 527 HISTORY AND SOCIAL STUDIES AND INTEGRATED ARTS (4)****R** Weeks 1-8 and 14-16: Friday, 9:00-11:50 a.m., and Weeks 9-13: Monday, 1:00-2:50 p.m.

Prerequisite: Must be officially admitted to the Multiple Subjects Credential Program. Students must register for at least 5 units of Field Experience (EDUC 560) concurrent with this course.

**EDUC 560 FIELDWORK/STUDENT TEACHING (5)****49506**

Weeks 3-8: Tuesday OR Thursday 9:00-11:50 a.m., and Weeks 9-13: Tuesday/Wednesday/Thursday/Friday, 8:00-3:30 p.m.

Prerequisites: Students must register for EDMS 522, 526, and 527 concurrent with this course.

### PART TIME MULTIPLE SUBJECT COHORT

**EDMS 522 LITERACY I / MULTICULTURAL-MULTILINGUAL (3)****R** Tuesday, 4:00-6:50 p.m.

Prerequisite: Must be officially admitted to the Multiple Subjects Credential Program. Students must register for at least one unit of Field Experience (EDUC 560) concurrent with this course.

**EDMS 526 MODERN METHODS IN MATHEMATICS TEACHING (3)****R** Thursday, 4:00-6:50 p.m.

Prerequisite: Must be officially admitted to the Multiple Subjects Credential Program. Students must register for at least one unit of Field Experience (EDUC 560) concurrent with this course.

**EDUC 560 FIELDWORK/STUDENT TEACHING (2)****49507**

TBA

Prerequisites: Students must register for EDMS 522 and 526 concurrent with this course.

## Alphabetical Course List

### Accounting

**ACCT 300 APPLIED MANAGERIAL ACCOUNTING (3)****49000**

Monday/Wednesday, 11:00-12:20 p.m.

**49001**

Tuesday, 7:00-9:50 p.m.

### Anthropology

**ANTH 345 BIOANTHROPOLOGY (3)****49100**

Tuesday, 7:00-9:50 p.m.

### Art

**ART 108 VISUAL TECHNOLOGY (3)****49050**

Monday/Wednesday, 8:00-9:50 a.m.

**Lab fee \$15****ART 204 GRAPHIC DESIGN (3)****49051**

Tuesday/Thursday, 7:00-9:50 p.m.

**Lab fee \$15****ART 205 MULTIMEDIA (3)****49052**

Tuesday/Thursday, 4:00-6:50 p.m.

**Lab fee \$15****ART 206 ANIMATION (3)****49053**

Monday/Wednesday, 4:00-6:50 p.m.

**Lab fee \$15**



- ART 310 TWO-DIMENSIONAL MEDIA AND PROCESSES (3)**  
49054 Monday/Wednesday, 10:00-12:50 p.m.  
**Lab fee \$15**
- ART 311 THREE-DIMENSIONAL MEDIA AND PROCESSES (3)**  
49055 Tuesday/Thursday, 10:00-12:50 p.m.  
**Lab fee \$15**
- ART 312 TIME-BASED DIGITAL MEDIA AND PROCESSES (3)**  
49056 Monday/Wednesday, 1:00-3:50 p.m.  
**Lab fee \$15**
- ART 313 COMMUNICATION DESIGN TECHNOLOGY MEDIA AND PROCESSES (3)**  
49057 Tuesday/Thursday, 1:00-3:50 p.m.  
**Lab fee \$15**
- ART 330 CRITICAL THINKING IN A VISUAL WORLD (3)**  
49058 Monday/Wednesday, 11:00-12:20 p.m.
- ART 331 ART AND MASS MEDIA (3)**  
49060 Monday, 7:00-9:50 p.m.  
49059 Tuesday/Thursday, 9:30-10:50 a.m.
- ART 332 MULTICULTURAL ART MOVEMENTS (3)**  
49061 Wednesday, 7:00-9:50 p.m.
- ART 431 EUROPEAN RENAISSANCE LITERATURE AND ART (3)**  
49062 Wednesday, 1:00-3:50 p.m.

### Biology

- BIOL 200 PRINCIPLES OF ORGANISMAL AND POPULATION BIOLOGY (3)**  
49150 Tuesday/Thursday, 7:00-8:20 p.m.  
**BIOL 200L PRINCIPLES OF ORGANISMAL AND POPULATION BIOLOGY LAB (Must be taken concurrently with BIOL 200) (1)**  
49152 Monday, 1:00-3:50 p.m.  
49151 Monday, 5:00-7:50 p.m.  
**Lab fee: \$40**
- BIOL 201 PRINCIPLES OF CELL AND MOLECULAR BIOLOGY (3)**  
49153 Tuesday/Thursday, 1:00-2:20 p.m.  
**BIOL 201L PRINCIPLES OF CELL AND MOLECULAR BIOLOGY LAB (Must be taken concurrently with BIOL 201) (1)**  
49154 Friday, 10:00-12:50 p.m.  
**Lab fee \$40**
- BIOL 202 BIOSTATISTICS (3)**  
49155 Monday/Wednesday, 4:00-5:20 p.m.  
49156 Tuesday/Thursday, 9:30-10:50 a.m.  
Also listed as MATH 202.  
**Lab fee \$25**

- BIOL 300 CELL PHYSIOLOGY (3)**  
49157 Tuesday/Thursday, 11:00-12:20 p.m.  
**BIOL 300L CELL PHYSIOLOGY LAB (Must be taken concurrently with BIOL 300) (1)**  
49158 Tuesday, 1:00-3:50 p.m.  
49159 Wednesday, 1:00-3:50 p.m.  
49160 Thursday, 1:00-3:50 p.m.  
**Lab Fee: \$40**
- BIOL 302 GENETICS AND EVOLUTION (3)**  
49161 Monday/Wednesday, 11:00-12:20 p.m.
- BIOL 330 ECOLOGY AND THE ENVIRONMENT (3)**  
49162 Tuesday/Thursday, 9:00-10:20 a.m.  
**BIOL 330L ECOLOGY AND THE ENVIRONMENT LAB (Must be taken concurrently with BIOL 330) (1)**  
49163 Tuesday, 1:00-3:50 p.m.  
49164 Wednesday, 1:00-3:50 p.m.  
49165 Thursday, 1:00-3:50 p.m.  
Also listed as ANTH 330.  
**Lab Fee: \$40**
- BIOL 410 COMPUTER APPLICATIONS IN BIOMEDICAL FIELDS (3)**  
49168 Monday/Friday, 1:00-2:20 p.m.  
Also listed as COMP 410.  
**Lab Fee: \$40**

### Business

- BUS 340 BUSINESS AND MONEY IN THE AMERICAN NOVEL (3)**  
49200 Monday/Wednesday, 1:00-2:20 p.m.  
Also listed as ENGL 340, ECON 340.
- BUS 341 DRUG DISCOVERY AND DEVELOPMENT (3)**  
49201 Tuesday/Thursday, 12:00-1:20 p.m.  
Also listed as CHEM 341, ECON 341.
- BUS 424 BUSINESS IN ITS SOCIAL SETTING (3)**  
49203 Thursday, 7:00-9:50 p.m.

### Chemistry

- CHEM 170 PHYSICAL SCIENCES FOR THE ELEMENTARY SCHOOL TEACHER (4)**  
49252 Monday/Wednesday, 1:00-3:50 p.m.  
49253 Tuesday/Thursday, 4:00-6:50 p.m.  
**Lab fee: \$15**
- CHEM 311 ORGANIC CHEMISTRY I (3)**  
49254 Monday/Wednesday/Friday, 10:00-10:50 a.m.
- CHEM 312 ORGANIC CHEMISTRY I LAB (1)**  
49255 Monday, 1:00-3:50 p.m.  
49256 Wednesday, 1:00-3:50 p.m.  
49257 Saturday, 9:00-11:50 a.m.  
49258 Saturday, 1:00-3:50 p.m.  
**Lab Fee: \$25, and \$25 refundable breakage card fee.**
- CHEM 313 ORGANIC CHEMISTRY I LEARNING COMMUNITY (1)**  
49259 Monday, 1:00-1:50 p.m.  
49260 Friday, 1:00-1:50 p.m.





**CHEM 341 DRUG DISCOVERY AND DEVELOPMENT (3)**  
**49261** Tuesday/Thursday, 12:00-1:20 p.m.  
Also listed as BUS 341, ECON 341.

### Computer Information Systems

**CIS 310 MANAGEMENT INFORMATION SYSTEMS (3)**  
**49300** Tuesday/Thursday, 2:00-3:50 p.m.  
**49301** Thursday, 4:00-6:50 p.m.  
Prerequisites: CIS 110.

### Computer Science

**COMP 101 COMPUTER LITERACY (3)**  
**49350** Tuesday/Thursday, 11:00-12:20 p.m.  
**Lab fee: \$40**

**COMP 150 OBJECT ORIENTED PROGRAMMING (4)**  
**49351** Monday/Wednesday, 10:00-10:50 a.m. and Friday,  
9:00-10:50 a.m.  
**49352** Monday/Wednesday, 4:00-5:50 p.m.  
**Lab Fee: \$40**

**COMP 151 DATA STRUCTURES (4)**  
**49353** Monday/Wednesday, 3:00-3:50 p.m. and  
Friday, 3:00-4:50 p.m.  
**Lab fee: \$40**

**COMP 162 COMPUTER ARCHITECTURE AND ASSEMBLY  
LANGUAGE (3)**  
**49354** Monday/Wednesday/Friday, 12:00-12:50 p.m.  
**Lab fee: \$40**

**COMP 232 PROGRAMMING LANGUAGES (3)**  
**49355** Tuesday/Thursday, 12:30-1:50 p.m.  
**Lab fee: \$40**

**COMP 410 COMPUTER APPLICATIONS IN BIOMEDICAL  
FIELDS (3)**  
**49356** Monday/Friday, 1:00-2:20 p.m.  
Also listed as BIOL 410.  
**Lab fee: \$40**

**COMP 492 INTERNSHIP (3)**  
**49357** TBA

**COMP 497 DIRECTED STUDY (3)**  
**49358** TBA

### Economics

**ECON 300 FUNDAMENTALS OF ECONOMICS (3)**  
**49400** Tuesday/Thursday, 1:00-2:20 p.m.

**ECON 310 INTERMEDIATE MICROECONOMICS (3)**  
**49402** Tuesday/Thursday, 11:00-12:20 p.m.

**ECON 320 MONEY AND BANKING (3)**  
**49403** Wednesday, 4:00-6:50 p.m.

**ECON 329 MANAGERIAL ECONOMICS (3)**  
**49404** Friday, 9:00-11:50 a.m.

**ECON 340 BUSINESS AND MONEY IN THE AMERICAN  
NOVEL (3)**  
**49406** Monday/Wednesday, 1:00-2:20 p.m.  
Also listed as BUS 340, ENGL 340.

**ECON 341 DRUG DISCOVERY AND DEVELOPMENT (3)**  
**49407** Tuesday/Thursday, 12:00-1:20 p.m.  
Also listed as BUS 341, CHEM 341.

**ECON 343 CAPITAL THEORY (3)**  
**49405** Monday/Wednesday 4:00-5:20 p.m.  
Also listed as FIN 343.

**ECON 362 INTRODUCTION TO ENVIRONMENTAL  
ECONOMICS (3)**  
**49401** Tuesday/Thursday, 2:30-3:50 p.m.

### Education Multiple Subjects Program

**EDMS 522 LITERACY I / MULTICULTURAL-  
MULTILINGUAL (3)**  
**R** Weeks 1-8 and 14-16: Monday, 9:00-11:50 a.m., and  
Weeks 9-13: Monday, 9:00-10:50 a.m.  
Prerequisite: Must be officially admitted to the Multiple  
Subjects Credential Program. Students must register for  
at least 5 units of Field Experience (EDUC 560)  
concurrent with this course. **(Full Time Cohort)**

**EDMS 522 LITERACY I / MULTICULTURAL-  
MULTILINGUAL (3)**  
**R** Tuesday, 4:00-6:50 p.m.  
Prerequisite: Must be officially admitted to the Multiple  
Subjects Credential Program. Students must register for  
at least one unit of Field Experience (EDUC 560)  
concurrent with this course. **(Part Time Cohort)**

**EDMS 526 MODERN METHODS IN MATHEMATICS  
TEACHING (3)**  
**R** Weeks 1-8 and 14-16: Wednesday, 9:00-11:50 a.m., and  
Weeks 9-13: Monday, 11:00-12:50 p.m.  
Prerequisite: Must be officially admitted to the Multiple  
Subjects Credential Program. Students must register for  
at least 5 units of Field Experience (EDUC 560)  
concurrent with this course. **(Full Time Cohort)**

**EDMS 526 MODERN METHODS IN MATHEMATICS  
TEACHING (3)**  
**R** Thursday, 4:00-6:50 p.m.  
Prerequisite: Must be officially admitted to the Multiple  
Subjects Credential Program. Students must register for  
at least one unit of Field Experience (EDUC 560)  
concurrent with this course. **(Part Time Cohort)**

**EDMS 527 HISTORY AND SOCIAL STUDIES AND  
INTEGRATED ARTS (4)**  
**R** Weeks 1-8 and 14-16: Friday, 9:00-11:50 a.m., and  
Weeks 9-13: Monday, 1:00-2:50 p.m.  
Prerequisite: Must be officially admitted to the Multiple  
Subjects Credential Program. Students must register for  
at least 5 units of Field Experience (EDUC 560)  
concurrent with this course. **(Full Time Cohort)**



## Education

- EDUC 320 EDUCATION IN MODERN SOCIETY (3)**  
**49509** Monday/Wednesday/Friday, 11:00-11:50 a.m.  
**49510** Wednesday, 4:00-6:50 p.m.
- EDUC 510 LEARNING THEORY AND DEVELOPMENT APPLIED IN MULTICULTURAL EDUCATION CONTEXTS (3)**  
**49500** Wednesday, 1:00-3:50 p.m.  
**49501** Thursday, 4:00-6:50 p.m.
- EDUC 512 EQUITY, DIVERSITY AND FOUNDATIONS OF SCHOOLING (3)**  
**49503** Wednesday, 4:00-6:50 p.m.  
**49502** Thursday, 1:00-3:50 p.m.
- EDUC 520 OBSERVING AND GUIDING BEHAVIOR IN MULTILINGUAL/MULTICULTURAL AND INCLUSIVE CLASSROOMS (3)**  
**49504** Monday, 1:00-3:50 p.m.  
**49505** Tuesday, 4:00-6:50 p.m.  
 Prerequisites: Students must register for at least one unit of Field Experience (EDUC 560) concurrent with this course.
- EDUC 560 FIELDWORK/STUDENT TEACHING (5)**  
**49506** Weeks 3-8: Tuesday OR Thursday 9:00-11:50 a.m., and Weeks 9-13: Tuesday/Wednesday/Thursday/Friday, 8:00-3:30 p.m.  
 Prerequisites: Students must register for EDMS 522, 526, and 527 concurrent with this course. **(Full Time Cohort)**
- EDUC 560 FIELDWORK/STUDENT TEACHING (2)**  
**49507** TBA  
 Prerequisites: Students must register for EDMS 522 and 526 concurrent with this course. **(Part Time Cohort)**

## English

- ENGL 310 RESEARCH METHODS (3)**  
**49552** Monday/Wednesday/Friday, 9:00-9:50 a.m.  
**49553** Tuesday/Thursday, 2:00-3:20 p.m.
- ENGL 312 CHILDREN'S LITERATURE (3)**  
**49554** Monday/Wednesday/Friday, 10:00-10:50 a.m.  
**49555** Tuesday/Thursday, 2:00-3:20 p.m.
- ENGL 315 LINGUISTICS (3)**  
**49556** Monday, 4:00-6:50 p.m.  
**49557** Tuesday/Thursday, 5:30-6:50 p.m.
- ENGL 326 MAJOR BRITISH AUTHORS (3)**  
**49558** Tuesday/Thursday, 10:00-11:20 a.m.
- ENGL 330 WRITING IN THE DISCIPLINES (3)**  
**49550** Monday/Wednesday/Friday, 10:00-10:50 a.m.  
**49551** Tuesday, 4:00-6:50 p.m.
- ENGL 337 LITERATURE OF THE ENVIRONMENT (3)**  
**49560** Monday/Wednesday/Friday, 3:00-3:50 p.m.

- ENGL 340 BUSINESS AND MONEY IN THE AMERICAN NOVEL (3)**  
**49561** Monday/Wednesday, 1:00-2:20 p.m.  
 Also listed as BUS 340, ECON 340.
- ENGL 431 EUROPEAN RENAISSANCE LITERATURE AND ART (3)**  
**49562** Wednesday, 1:00-3:50 p.m.  
 Also listed as ART 431.
- ENGL 449 MULTICULTURAL LITERATURE (3)**  
**49563** Wednesday, 4:00-6:50 p.m.
- ENGL 460 PERSPECTIVES IN CREATIVE WRITING (3)**  
**49564** Tuesday/Thursday, 1:00-2:20 p.m.
- ENGL 475 LANGUAGE IN SOCIAL CONTEXT (3)**  
**49567** Monday, 9:00-11:50 a.m.  
**49565** Tuesday, 4:00-6:50 p.m.  
**49566** Thursday, 4:00-6:50 p.m.
- ENGL 482 TECHNICAL WRITING (3)**  
**49568** Tuesday, 9:30-12:20 p.m.
- ENGL 483 TECHNICAL VISUAL COMMUNICATION (3)**  
**49570** Monday, 7:00-9:50 p.m.  
**49569** Thursday, 9:30-12:20 a.m.

## Environmental Science and Resource Management

- ESRM 330 ENVIRONMENTAL INSTITUTIONS, LAW AND REGULATION (3)**  
**49630** Tuesday/Thursday, 4:00-5:20 p.m.

## Finance

- FIN 300 BUSINESS FINANCE (3)**  
**49650** Tuesday/Thursday, 1:00-2:20 p.m.  
**49651** Wednesday, 7:00-9:50 p.m.

## Geology

- GEO 321 ENVIRONMENTAL GEOLOGY (3)**  
**49575** Tuesday/Thursday, 10:30-11:50 p.m.

## History

- HIST 350 CHICANO HISTORY AND CULTURE (3)**  
**49576** Thursday, 7:00-9:50 p.m.
- HIST 365 THEMES IN WORLD CIVILIZATION BEFORE 1500 (3)**  
**49577** Tuesday, 9:00-11:50 a.m.
- HIST 366 THEMES IN WORLD CIVILIZATION SINCE 1500 (3)**  
**49578** Monday, 7:00-9:50 p.m.
- HIST 369 CALIFORNIA HISTORY AND CULTURE (3)**  
**49579** Wednesday, 7:00-9:50 p.m.



## Mathematics

**MATH 140 CALCULUS FOR BUSINESS APPLICATIONS I (3)**  
**49600** Tuesday/Thursday, 3:00-4:20 p.m.  
**Lab fee: \$25**

**MATH 150 CALCULUS I (4)**  
**49601** Tuesday/Thursday, 4:00-5:50 p.m.  
**Lab Fee \$25**

**MATH 208 MODERN MATHEMATICS FOR ELEMENTARY SCHOOL TEACHERS (3)**  
**49605** Monday/Wednesday/Friday, 12:00-12:50 p.m.  
**49604** Monday/Wednesday/Friday, 3:00-3:50 p.m.  
**Lab fee: \$25**

**MATH 230 LOGIC (3)**  
**49606** Monday/Wednesday, 8:30-9:50 a.m.

**MATH 240 INTRODUCTION TO LINEAR ALGEBRA (3)**  
**49607** Monday/Wednesday/Friday, 2:00-2:50 p.m.  
**Lab fee: \$25**

**MATH 300 DISCRETE MATHEMATICS (3)**  
**49608** Monday/Wednesday/Friday, 1:00-1:50 p.m.

**MATH 340 STATISTICS FOR BUSINESS AND ECONOMICS (3)**  
**49609** Monday/Wednesday, 1:00-2:20 p.m.  
**49610** Monday/Wednesday, 3:00-4:20 p.m.  
**49611** Tuesday/Thursday, 5:30-6:50 p.m.  
**Lab fee: \$25**

**MATH 342 PROBABILITY AND STATISTICS (3)**  
**49612** Monday/Wednesday/Friday, 11:00-11:50 a.m.  
**Lab fee: \$25**

**MATH 492 INTERNSHIP (3)**  
**49615** TBA

**MATH 497 DIRECTED STUDY (3)**  
**49616** TBA

## Management

**MGT 307 MANAGEMENT OF ORGANIZATIONS (3)**  
**49675** Monday/Wednesday, 1:00-2:20 p.m.  
**49676** Tuesday, 4:00-6:50 p.m.

**MGT 310 MANAGEMENT OF INTERNATIONAL BUSINESS (3)**  
**49677** Thursday, 7:00-9:50 p.m.

**MGT 346 SCIENTIFIC AND PROFESSIONAL ETHICS (3)**  
**49679** Monday/Wednesday, 1:00-2:20 p.m.  
**49678** Wednesday, 4:00-6:50 p.m.  
Also listed as BIOL 346, CHEM 346, MATH 346.

## Marketing

**MKT 310 PRINCIPLES OF MARKETING (3)**  
**49700** Tuesday/Thursday, 9:30-10:50 a.m.  
**49701** Wednesday, 7:00-9:50 p.m.

## Physical Education

**PHED 302 MOTOR LEARNING FITNESS (3)**  
**49730** Monday/Wednesday/Friday, 9:00-9:50 a.m.  
**49731** Tuesday/Thursday, 4:00-5:20 p.m.

## Physics

**PHYS 200 GENERAL PHYSICS I (3)**  
**49750** Tuesday/Thursday, 1:00-2:20 p.m.  
**PHYS 200L GENERAL PHYSICS I LAB (Must be taken concurrently with PHYS 200) (1)**  
**49751** Tuesday/Thursday, 2:30-3:50 p.m.  
**Lab Fee: \$25**

## Psychology

**PSY 333 MEASUREMENT AND TESTING (3)**  
**49780** Tuesday/Thursday, 9:30-10:50 a.m.

**PSY 344 PSYCHOLOGY AND TRADITIONAL ASIAN THOUGHT (3)**  
**49781** Monday, 1:00-3:50 p.m.

**PSY 350 CLINICAL AND COUNSELING PSYCHOLOGY (3)**  
**49782** Tuesday, 7:00-9:50 p.m.

**PSY 461 TOPICS IN CHILD AND ADOLESCENT DEVELOPMENT (3)**  
**49783** Tuesday/Thursday 1:00-2:20 p.m.

## Special Education

**SPED 345 INDIVIDUALS WITH DISABILITIES (3)**  
**49800** Monday, 4:00-6:50 p.m.  
**49801** Tuesday, 1:00-3:50 p.m.  
**49802** Wednesday, 9:00-11:50 p.m.

## Theatre

**TH 333 MULTICULTURAL DRAMA IN PERFORMANCE/ PRODUCTION (3)**  
**49860** Tuesday, 7:00-9:50 p.m.  
Also listed as ENGL 333.



## Campus Services Directory

### Admissions & Records (Office of)

Location: Professional Building  
 Phone: (805) 437-8500  
 Fax: (805) 437-8509  
 Email: admissionsandrecords@csuci.edu  
 Writing: Admissions and Records  
 Cal State Channel Islands  
 One University Dr.  
 Camarillo, CA 93012

### Academic Affairs (Office of)

Location: Professional Building  
 Telephone: (805) 437-8441  
 Fax: (805) 437-8864  
 Writing: Office of Academic Affairs  
 Cal State Channel Islands  
 One University Dr.  
 Camarillo, CA. 93012

### Academic Advisement (General Advisement)

Location: Bell Tower  
 Telephone: (805) 437-8571  
 Fax: (805) 437-8857  
 Email: advisement@csuci.edu  
 Writing: Academic Advisement Offices  
 Cal State Channel Islands  
 One University Dr.  
 Camarillo, CA 93012

### Associated Students (See Office of Student Development)

### Bus Services (See Parking Services)

### Cashier's Office (See Student Financial Services)

### Clubs and Organizations (See Office of Student Development)

### Career, Health, Accommodations, Personal Counseling Services (C.H.A.P.s) Career Planning and Preparation

Location: Bell Tower 1st. floor  
 Phone: (805) 437-8510, TDD (805) 437-8510  
 Fax: (805) 437-8529  
 Email: chaps.career@csuci.edu  
 Writing: Career Development Services  
 Cal State Channel Islands  
 One University Dr.  
 Camarillo, CA 93012

### Credential Advisement

Location: Bell Tower 1st. floor  
 Phone: (805) 437-8571  
 Email: credentials@csuci.edu  
 Writing: Credential Advisement Office  
 Cal State Channel Islands  
 One University Dr.  
 Camarillo, CA 93012

### Disability Accommodation Services

Location: Bell Tower  
 Phone: (805) 437-8510, TDD (805) 437-8510  
 Fax: (805) 437-8529  
 Email: chaps.ada@csuci.edu  
 Writing: Disability Accommodation Services  
 Cal State Channel Islands  
 One University Dr.  
 Camarillo, CA 93012

### Extended Education (Office of)

Location: Professional Building  
 Phone: (805) 437-8580  
 Fax: (805) 437-8864  
 Writing: Office of Extended Education  
 Cal State Channel Islands  
 One University Dr.  
 Camarillo, CA 93012

### Financial Aid (Office of)

Location: Professional Building  
 Phone: (805) 437-8518, TDD (805) 437-8510  
 Fax: (805) 437-8509  
 Email: financial.aid@csuci.edu  
 Writing: Financial Aid Office  
 Cal State Channel Islands  
 One University Dr.  
 Camarillo, CA 93012

### Fitness Center (See Office of Student Development-Recreation)

### Judicial Affairs (See Office of Student Development)

### Library Services

Location: University Library  
 Phone: (805) 437-8561  
 Fax: (805) 437-8569  
 Writing: CSU Channel Islands Library  
 One University Dr.  
 Camarillo, CA 93012

### Lost and Found (See Police Department)

### Open University (See Office of Extended Education)

### Orientation (See Office of Student Development)

### Outreach and Recruitment (Offices of)

Location: Professional Building  
 Phone: (805) 437-8520  
 Fax: (805) 437-8519  
 Email: prospective.students@csuci.edu  
 Writing: Offices of Outreach and Recruitment  
 Cal State Channel Islands  
 One University Dr.  
 Camarillo, CA 93012



### **Parking Services (Office of Public Safety)**

Location: Parking/Police Offices  
Phone: (805) 437-8430  
Fax: (805) 437-8431  
Writing: Parking Services  
Cal State Channel Islands  
One University Dr.  
Camarillo, CA 93012

### **Personal & Psychological Counseling Services (See C.H.A.Ps)**

### **Police Department (Office of Public Safety)**

Location: Parking/Police Offices  
Non-Emergency Phone: (805) 437-8444  
Emergency Phone: 911  
Business Emergency: (805) 437-8888  
Fax: (805) 437-8431  
Writing: University Police Department  
Cal State Channel Islands  
One University Dr.  
Camarillo, CA 93012

### **President (Office of the)**

Location: Administration Building  
Phone: (805) 437-8410  
Fax: (805) 437-8424  
Writing: Office of the President  
Cal State Channel Islands  
One University Dr.  
Camarillo, CA 93012

### **Recreation & Leisure Services (See Office of Student Development)**

### **Student Financial Services (Cashiering)**

Location: Professional Building 1st. floor  
Phone: (805) 437-8533  
Fax: (805) 437-8509  
Writing: University Financial Services  
Cal State Channel Islands  
One University Dr.  
Camarillo, CA 93012

### **Student Affairs (Office of Vice President)**

Location: Bell Tower 2nd. floor  
Phone: (805) 437-8536, TDD (805) 437-8510  
Fax: (805) 437-8549  
Email: vp.studentaffairs@csuci.edu  
Writing: Vice President for Student Affairs  
Cal State Channel Islands  
One University Dr.  
Camarillo, CA 93012

### **Student Development (Office of OSD)**

Location: Bell Tower 2nd. floor  
Phone: (805) 437-8998, TDD (805) 437-8510  
Fax: (805) 437-8549  
Email: student.development@csuci.edu  
Writing: Office of Student Development  
Cal State Channel Islands  
One University Dr.  
Camarillo, CA 93012

#### Program Areas

Clubs and Organizations  
Judicial Affairs  
Orientation  
Recreation and Leisure Services  
Student Activities  
Student Leadership

### **Student Health Services**

Location: Health Center Building  
San Luis Avenue  
Phone: (805) 437-8828  
Fax: (805) 437-8829  
Email: chaps.health@csuci.edu  
Writing: Student Health Services  
Cal State Channel Islands  
One University Dr.  
Camarillo, CA 93012

### **Student I.D. (See Office of Student Development)**

### **Student Store (Bookstore)**

Location: Bell Tower 1st. floor  
Phone: (805) 437-8833  
Fax: (805) 437-8835  
Email: 0591mgr@fhcg.follett.com  
Writing: The Student Store  
One University Dr.  
Camarillo, CA 93012

### **Technology Center**

Location: Technology Center  
Phone: (805)-437-8552  
Fax: (805) 437-8555  
Email: helpdesk@csuci.edu  
Writing: Technology Center  
Cal State Channel Islands  
One University Dr.  
Camarillo, CA 93012

### **The Hub - "Student Union" (See Office of Student Development)**

### **Tours-Campus (See Office of Outreach and Recruitment)**

### **Transportation Services (See Parking Services)**





## Faculty and Staff Directory

### Academic Affairs

Berg, Gary	Director of Extended Education	437-8580
Chang, Joanne	Admissions Specialist	8534
Corelli, Julie	Faculty Support Coordinator	8815
Crawford, Shelley	Admissions Specialist	8532
Cuevas, Rosario	Faculty Support Coordinator	8570
Downes, Kathy	Admissions Specialist	8537
Flores, Sharon	Academic Support Assistant	8540
Hirschhorn, Gretchen	Admissions Evaluator	8504
Jones, Janice	Admissions Specialist	8534
Kirks, Heather	Mgr, Faculty Affairs & Academic Resources	8485
Le, Judilyn	Academic Support Assistant	8497
Lefevre, Steve	AVP for Academic Affairs & Director of CSUN @ Channel Islands	8540
MacMichael, Linda	Director of Admissions and Records	8531
McNeill, Alex	V.P. for Academic Affairs	8441
Parra, Brian	Academic/HR Assistant	8876
Saunders, Sue	Advisement Coordinator	8571
Schoenwald, Ira	AVP for Academic Affairs, Faculty Affairs and Academic Resources	8482
Tauber, Maria	Administrative Services Coordinator	8543
Thorpe, Barbara	AVP for Academic Affairs-Academic Programs	8441
Ullisse, Cindy	Academic Accounting	8544
Vargas, Leticia	Student Financial Services-Cashier	8533
Wakelee, Dan	Academic Affairs, Associate Director CSUN @ CI	8540
Wanberg, Jane	Academic Support Assistant	8492
Ward, Dianne	Admissions Evaluator	8503
Williams, Phyllis	Executive Assistant for Academic Affairs	8441

### Administration

Rush, Richard	President	437-8410
Coville, Joanne	V.P. Admin and Finance	8457
Flores, Art	AVP Human Resources	8490
Gill, Nancy	Assoc. Director Development	8456
Gonzales, Alma	V.P. University Advancement	8417
Harrington, Kate	University Controller	8890
Lucas, Ted	Exec. Asst to the President	8483
Smith, Carmen	Special Asst to the President	8410

### Faculty

Adams, Bill	Associate Prof. of Anthropology	437-8866
Aloisio, Simone	Assistant Prof. of Chemistry	8897
Baker, Harley	Assistant Prof. of Psychology	8896
Ballman, Terry	Associate Prof. of Spanish	8895
Barajas, Frank	Assistant Prof. of History	8862
Bleicher, Robert	Assistant Prof. of Education	8508
Buchanan, Merilyn	Assistant Prof. of Education	8579
Buschmann, Rainer	Assistant Prof. of History	8894
Castaneda, Lillian	Professor of Education	8872
Christopher, Renny	Associate Prof. of English	8893
Cordeiro, William	Professor of Management	8860

Costache, Irina	Associate Prof. of Fine Arts	8892
de Oca, Beatrice	Associate Prof. of Psychology	8891
Diamantis, Nikolaos	Assistant Prof. of Mathematics	8890
Dougherty, Geoffrey	Professor of Physics	8889
Grier, Jeanne	Assistant Prof. of Education	8886
Grzegorzczuk, Ivona	Associate Prof. of Mathematics	8868
Hampton, Phillip	Associate Prof. of Chemistry	8869
Karp, Joan	Professor of Special Education	8871
Kilpatrick, Jacque	Associate Prof. of English	8865
Lutze-Mann, Louise	Associate Prof. of Biology	8873
Mozingo, Nancy	Assistant Prof. of Biology	8888
Muraoka, Dennis	Professor of Economics	8861
Reilly, Jack	Professor of Fine Arts	8863
Rivera, Paul	Assistant Prof. of Economics	8887
Vaidya, Ashish	Professor of Economics	8885
Volkan, Kevin	Associate Prof. of Psychology	8867
Wang, Ching-Hua	Professor of Biology	8870
Wolfe, William	Associate Prof. of Computer Science	8884
Zacharias, Mark	Assistant Prof. of Environmental Science and Resource Management	8883

### Library

Adalian, Paul	University Librarian	437-8577
Garcia, Martha	Library Assistant	8561
Taylor, Evelyn	Lagomarsino Archives	8830
Wagoner, Loretta	Library Coordinator	8562

### Public Safety Offices

<b>Police</b>		
<b>Emergency</b>		<b>911</b>
Business Emergency		437-8888
Johnston, Steve	Administrative Police Sargent	8444
Young, Jeff	Chief of University Police	8444
<b>Parking Services</b>		
Doolittle, Lashanor	Business Services Coordinator	8433
Porras, Ray	Director of Parking Services	8430

### Student Affairs

Cantu, Veronica	Outreach Counselor	437-8522
Cruz, Octavio	Financial Aid Counselor	8527
Flores, Maria	EOP Counselor	8515
Guillen, Arjelia	Administrative Support Coordinator	8510
Morten, George	Dir. for Student Affairs, C.H.A.Ps	8510
Pencoff, Nick	Director of Financial Aid	8518
Reyes, Ginger	Outreach Counselor	8521
Sawyer, Wm. Gregory	V.P. for Student Affairs	8536
Zendejas, MariaElena	Financial Aid Assistant	8530

### Technology Center

HELPDESK		437-8552
Dase, MaryAnn	CIO, Information Technology	8452
Peterson, Tara	IT Administrative Coordinator	8559
Gutierrez, Robert	Telecommunications Manager	8507
Khan, Munawwar	AVP Information Technology	8452

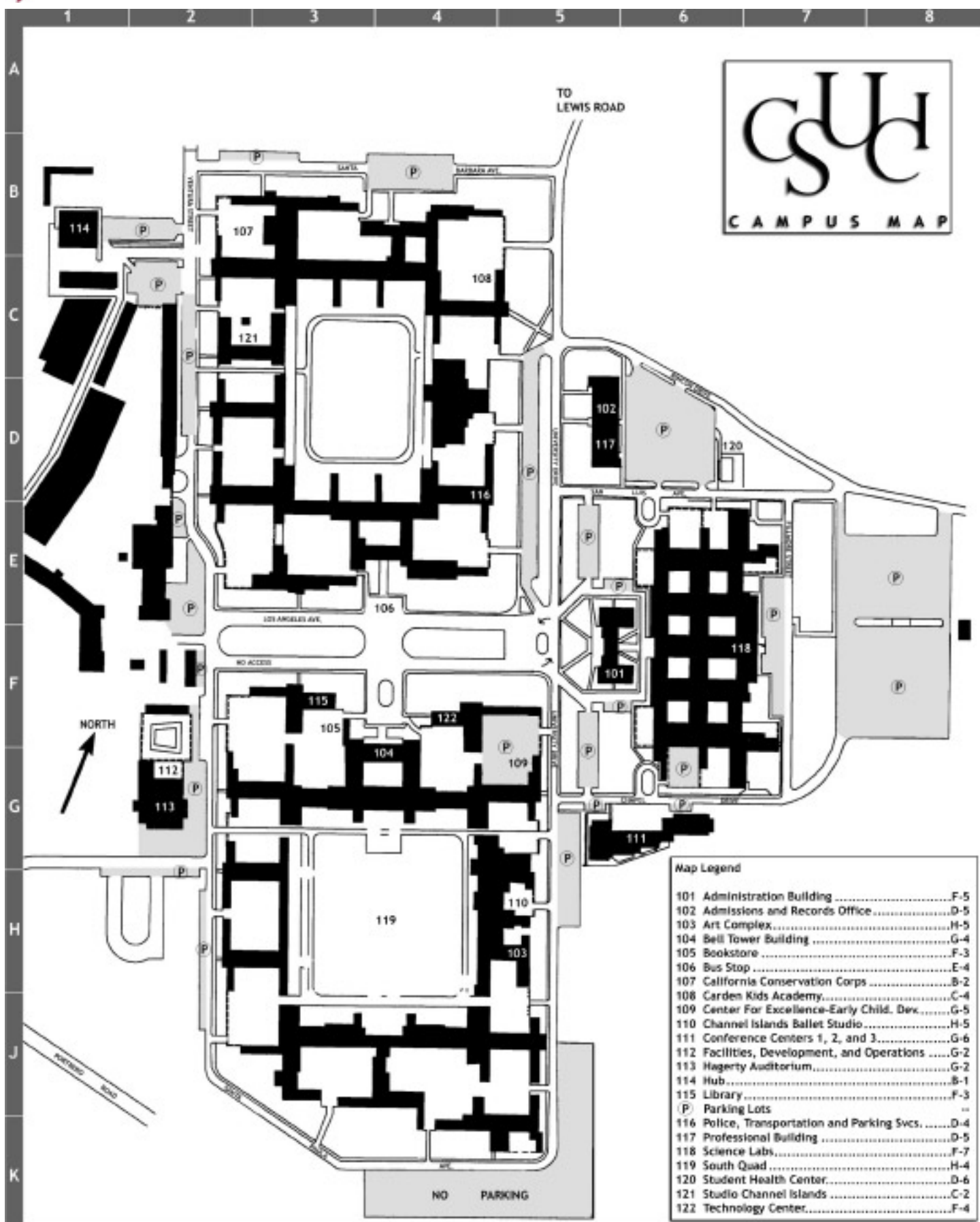

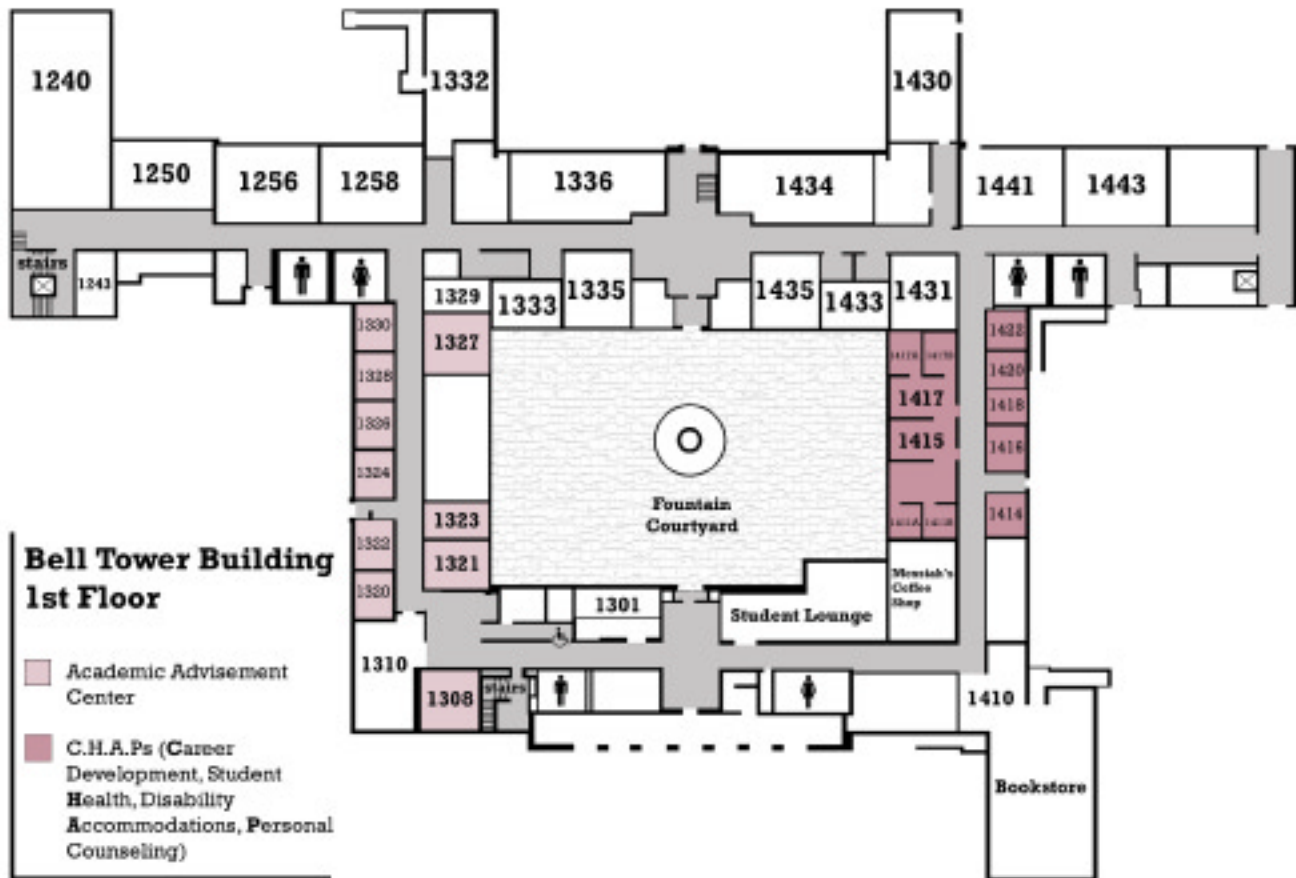



# Change of Program

## Approval Authorization for Change of Program and Withdrawal Chart

Calendar Period	Partial Withdrawal	Complete Withdrawal	Health Ctr. Withdrawal	Add a Class	Change Basis of Grading	Late Registration
<b>Week 1</b> 08/26/02 - 08/30/02	Drop using the Change of Program form without instructor's approval.	Drop using the Change of Program form without instructor's approval. Please see Academic Advisement Center.	Approval of Health Center for complete medical withdrawal.	Add using the Change of Program form with instructor's approval.	File Change of Program at Admissions and Records.	Pay fees and \$25 late fee in advance. Add using the Change of Program form with instructor's approval.
<b>Week 2</b> 09/03/02 - 09/06/02	Drop using the Change of Program form without instructor's approval.	Drop using the Change of Program form without instructor's approval. Please see Academic Advisement Center.	Approval of Health Center for complete medical withdrawal.	Add using the Change of Program form with instructor's approval.	File Change of Program at Admissions and Records.	Pay fees and \$25 late fee in advance. Add using the Change of Program form with instructor's approval.

**Regulations for the Change of Program for the week following Week 2 of the semester will be available in the Office of Admissions and Records. Please make every effort to complete all your changes during the first two weeks of the semester.**

\* Student eligibility for Financial Aid is based on enrollment. A student who completely withdraws from a period of enrollment may be subject to REPAYMENT (including medical withdrawals). If you are a financial aid recipient please consult a Financial Aid representative for additional information.

### Criteria for Late Add/Drop or Changes in the Basis of Grading

Students should note that a deficient academic performance is not a sufficient reason for dropping a class or changing the basis of grading.

The following examples do NOT meet the "serious and compelling/no viable alternative" standard to justify a "W" for dropping a course:

Need to work because of ordinary financial considerations or opportunity; encountered a situation which should have been anticipated, such as the need to have transportation, the need to pay for ordinary living expenses, the need for child care; dissatisfaction with course material, instructor, instructional method, or class intensity; lack of motivation or no longer relevant to academic interests, failing the class or receiving less-than-desired-grade; participation in extracurricular activities; or academic overload and cannot keep up in all classes.

All approvals for Changes of Program must be dated and secured within 14 days of the first approval received. The form must be filed at the Office of Admissions and Records.

A medical withdrawal usually constitutes complete withdrawal from the University for the academic period in question. In cases where medical evidence and the specific physical demands and environment of the classes overwhelmingly support withdrawal from only a portion of a student's program of study, partial withdrawals may be permitted. Medical withdrawals will be granted solely for established medical purposes prior to a student taking final exams. Medical withdrawals due to illness in the family will be granted only if the attending physician stipulates that the student is needed to care for the family member. A medical reevaluation is frequently required prior to readmission. The necessary forms for a medical withdrawal can be obtained at the Student Health Center. Approval of the instructor and Academic Affairs must be obtained for each class for which a medical withdrawal is sought. If you are a financial aid recipient please consult a financial aid representative.



### California State University Channel Islands Fall 2002 Inaugural Schedule of Classes

#### Editor

Maria Tauber, Coordinator of Administrative Services

#### Design, Layout, Graphics, Photography

Josh Schoenwald

#### Front Cover Design

Mustang Marketing, Westlake Village, CA